

Surface features and levels have been surveyed to meet the requested scope of works accuracy. The surface may be contoured to depict topography or defined only by spot heights. For clarity on hard copy some level information is not shown, refer to 3D digital file. Above ground indicators (markers) of underground services are located where visible. Third parties utilising this information should confirm the capture accuracies meet requirements prior to use. This note is an integral part of this plan.

The depicted Precalculated boundaries shall be treated as proposed only and may be subject to alterations in dimensions or areas prior to Deposited Plan lodgement at Landgate. The depicted boundary locations are a graphical representation only, therefore their position is not guaranteed by MNG unless stated otherwise. Re-establishment of lot boundaries by a Licensed Surveyor is recommended for any works on or about a boundary. This note is an integral part of this plan.

This survey has been completed to CLASS 2 Accuracy  
 Horizontal Accuracy ± 20mm  
 Vertical Accuracy ± 20mm  
 This note is an integral part of this plan.

GOATCHER VISTA

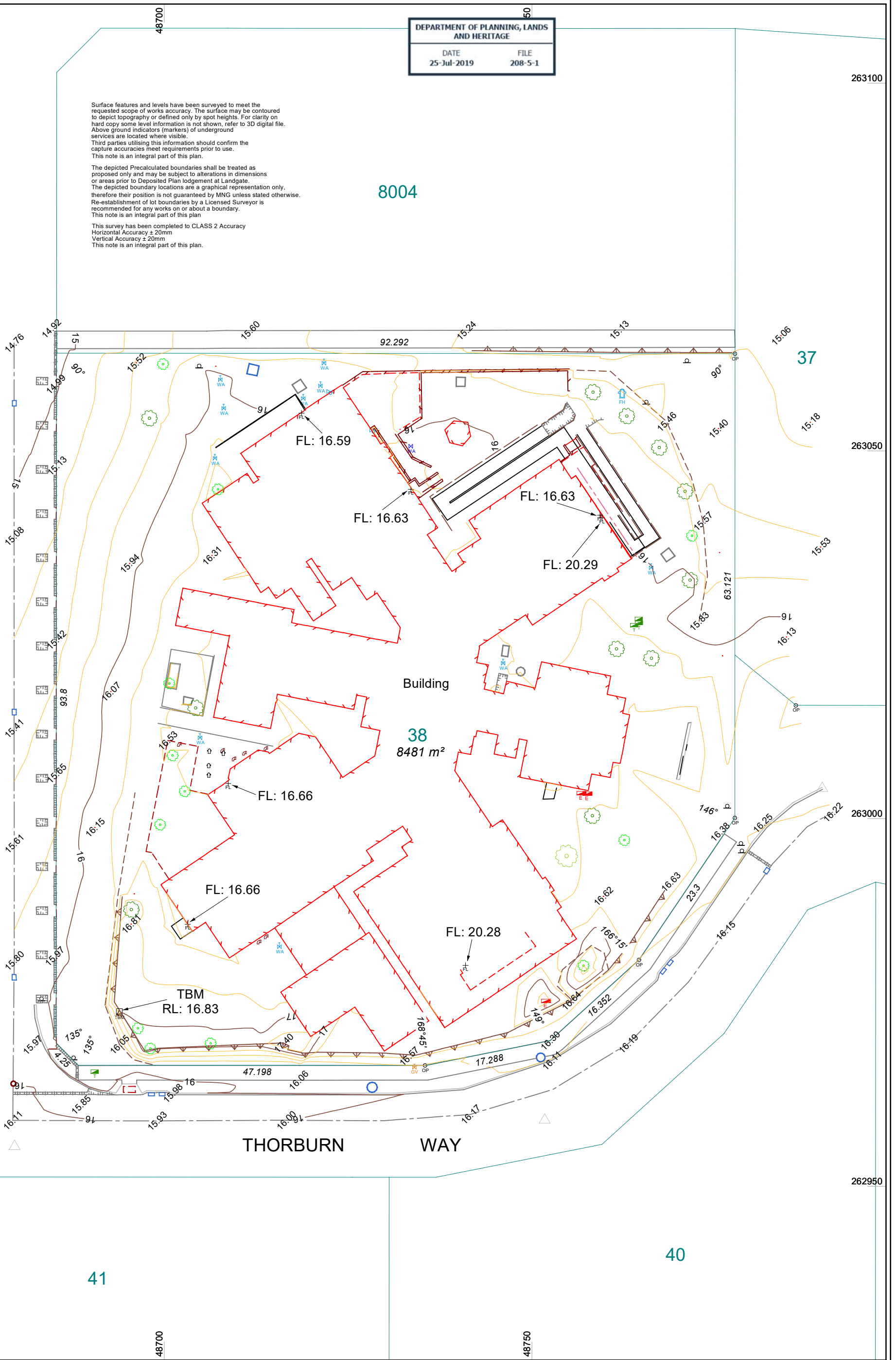

263100 263100  
 263050 263050  
 263000 263000  
 262950 262950  
 43 37  
 42 40  
 41

Rev.	Description	Drawn	Date	Checked
A	Initial Issue	JCR	21/06/2019	NSI

Surveyor:- MNG  
 Survey Date:- 19/06/2019  
 Precal/Cad:- 20/06/2019

ISO 9001 Quality Management  
 AS/NZS 4801:2001 Occupational Health and Safety Management

FS 565311 OSH 591267

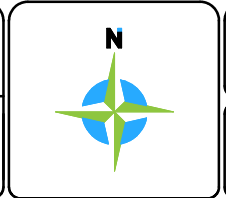

**LOT 38 - LEMNOS STREET SHENTON PARK Detail Survey**

CLIENT:  
**FINI GROUP PTY LTD**

The contents of this plan are current and correct as of the date stated within the revision panel. All consultants and persons wishing to utilise this data should satisfy themselves of this plan's currency by contacting the McMullen Nolan Group.

Project Mgr: Nigel Simpson Datum: PCG94 / AHD

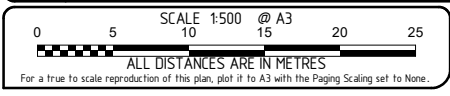

The boundaries shown on this plan were not re-established as part of this survey, therefore this plan does not guarantee their accuracy. Existing easements, encumbrance or interest are not depicted and a title search is recommended to obtain this information. Re-establishment of the cadastral boundaries is recommended for any proposed works on or near existing boundaries.

**MNG** MCMULLEN NOLAN GROUP  
 Level 1, 2 Sabre Crescent  
 Jandakot, W.A. 6164  
 PO Box 3526, Success  
 W.A. 6964, Australia  
 Offices in: Broome, Bunbury, Kununurra, Newman, Port Hedland

Tel: (08) 6436 1599  
 Fax: (08) 6436 1500  
 info@mngsurvey.com.au  
 www.mngsurvey.com.au  
 ABN 90 009 363 311

<b>101090 - DE - 004 - A</b>			
Job Number	Type	Plan Number	Revision

ROAD FEATURES	COMMUNICATION	SEWER	GROUND FEATURES	ROAD FEATURES	STRUCTURE	GROUND FEATURE	ELECTRICAL	UNDERGROUND SERVICES - DIRECT MEASUREMENT - CLASS A
Traffic Junction Box	Telstra Pit	Sewer Vent	Natural Surface	Edge Of Bitumen	Bridge	Major Contour	Variable Message Sign	Spatial Cadastral Database - SCDB (WA)
Traffic Signals - 1 Aspect	Telstra Pillar	Sewer Line Marker	Aerial Survey Marker	Road Shoulder	Abutment	Minor Contour	Electrical Structure String	Underground Amcom Cable
Traffic Signals - 2 Aspect	Telstra Marker	Sewer Inspection Shaft	VEGETATION	Edge Of Unsealed Road	Columns	Bank Bottom	Overhead Powerlines - Null Height	Underground Drainage Pipe
Traffic Signals - 3 Aspect	Telstra Pole	Sewer Inspection Opening	Tree Details - Canopy & Trunk	On Road	Piers	Bank Top	Overhead Powerlines - True Height	Underground Western Power Comms
Traffic Signals - 4 Aspect	Telephone Booth	Sewer Manhole	Tree 0.1m-0.3m Trunk Diameter	Centre Of Road	Underpass	Line Of Levels	High Tension Power Lines - Null Height	Underground Gas Line
Pedestrian Signals	Emergency Phone	RAIL	Tree 0.3m-0.5m Trunk Diameter	Kerb Top	Ramp	Levee Top	High Tension Power Lines - True Height	Underground MRWA Comms
Sign On One Pole	Antenna	Rail Traffic Signals	Tree 0.5m-1.0m Trunk Diameter	Kerb Bottom	Steps/Stairs	Levee Bottom	Unidentified Service Pit	Underground MRWA Power
Sign Multiple Poles	Telstra Elevated Joint	Rail Traffic Control Box	Tree > 1.0m Trunk Diameter	Cattle Grid	Edge Of Concrete	Rock Outcrop	Telstra Cable	Underground NBN Fibre
Overhead Sign	Cable Marker (Optus)	Rail Telephone Box	Bush	Centre Of Driveway	Bus Shelter	Ridge Line	Amcom Cable	Underground Next Gen Comms
Traffic Controller Box	Telstra Tower	Rail Cable Pit	Die Back Area - Marker	Edge Of Driveway	Memorial	Borrow Pit	Water Pipe	Underground Optus Fibre_Optic
Finger Sign	Communication Manhole	Rail Cable Marker	Nesting Tree	Pedestrian Ramp	Ruin	Earthworks Area	Gas Line	Underground Rail Services
Traffic Earth Pit	WATER	Rail SLK Post	Tree Trunk / Stump	Pedestrian Crosswalk	Building / Structure	Ground Subsidence	DRAINAGE	Underground Sewer Pipe
Police Traffic Camera	Water Meter	Manhole - Rail Cable	Grass Tree	Track	Awning	Rock Pitching	Drainage Pipe	Underground Telstra Copper
Guide Post	Water Stop Valve	STRUCTURE	SURVEY CONTROL	Parking Bay	Shed	VEGETATION	Drainage Culvert	Underground Unknown Service
Km Marker	Hydrant (Ground Level)	Deck Level	Star Iron Picket	Line Markings 1m Line & 1m Gap	Verandah	Tree Line/Canopy	Floodway	Underground Telephone
Traffic Count	Hydrant (Pillar)	Floor Level	Trig Point	Line Markings 1m Line & 3m Gap	Door Opening	Bush Line	Waterways Cross Section	Underground Water Pipe
ELECTRICAL	Water Bore	Column Centre	SSM	Line Markings 3m Line & 9m Gap	Window	Hedge	MAIN ROADS - SURFACE LOCATION - CLASS B	Underground Retention Pipe
Earth Pit	Stand Pipe	GENERAL	Bench Mark	Lane Marking 9m*3m GAP	Roof Gutter Line	Garden Bed	AMCOM Cable - Surface Location - (Depth Below)	
Electrical Pillar	Reticulation Sprinkler	Clothes Hoist	Photo Point	Lane Marking - Audible	Roof Ridge Line	Lawn Area	Drainage Pipe / Stormwater - Surface Location - (Depth Below)	
Electrical Dome	Reticulation Control Valve	Air Conditioner	Cadastral Peg/Post	Shared Pathway - Guide Line 900mm*300mm GAP	Top Of Wall	Vineyard	Electrical Cable - Surface Location - (Depth Below)	
Light Pole - Directional	Well	Marker Unk/Undefined	Reference Peg	Footpath/Shared Path - Give Way 200mm*200mm GAP	Brick Wall	Orchard	Western Power Communication - Surface Location - (Depth Below)	
Power Pole	Water Main Marker	Undefined Manhole	R.PEG	Giveway/Hold/Turn Lines 600mm*600mm GAP	Concrete Wall	Nursery	Gas Line - Surface Location - (Depth Below)	
Transformer Single Pole	Water Tap	Control Of Access Sign	Alignment Control	Double Barrier Line	Livestock Grid	Market Garden	MRWA Communication - Surface Location - (Depth Below)	
Stay Pole	Flushing Point	Count Station	Spring Head Nail	Overtaking Lane Left	Mine Shaft	Recreational Area	MRWA Power - Surface Location - (Depth Below)	
Steel Wire Anchor	Air Valve	AD Advertising Sign	Spike	Overtaking Lane Right	Mine Workings	Trunk Circumference Circle	Underground NBN Fibre - Surface Location - (Depth Below)	
High Mast Lighting	Peizometer	Windmill	TBM	Single Solid Line	Koppa Logging Fence	Edge Of Creek/Water	Next Gen Communication - Surface Location - (Depth Below)	
Electrical Cable Marker	Hydrant Booster Box	Stock Trough	Peg Placed / Found	Arrow Straight	Fence/Gate	Centre Of Channel	Optus Copper - Surface Location - (Depth Below)	
MRWA Cable Marker	Gas Marker	LITTER BIN	TROUGH	Arrow Straight/Left	Wall	Wet Area	Rail Services - Surface Location - (Depth Below)	
MRWA Electrical Cable Box	Gas Valve	Mail Box	MAIL	Arrow Straight/Right	Retaining Wall	Flood Level Line	Sewer Pipe - Surface Location - (Depth Below)	
Electrical Cable Pit/Box	Gas Test Valve	Parking Meter	MAIL	Arrow Left	Boundary Line	Waterways Cross Section	Telstra - Surface Location - (Depth Below)	
MRWA Distribution Board	LPG Tank	Bus Stop	BUS	Arrow Right	Footpath	Waterways Cross Section	Unknown Service - Surface Location - (Depth Below)	
High Tension Power Pole	Gas Test Pit	Ticket Machine	BORE	Arrow 3 Ways	Gas Cylinder/Tank	Waterways Cross Section	Telstra Fibre Optic - Surface Location - (Depth Below)	
Electrical Supply Pole	Gas Manhole	Borehole	FLAG	Arrow Right & Left	Brick Paving	Waterways Cross Section	Water Pipe - Surface Location - (Depth Below)	
Ground Floodlight	DRAINAGE	Flag Pole	BOLLARD	Arrow U-Turn	Bike Rack	Waterways Cross Section	Reticulation - Surface Location - (Depth Below)	
MRWA Electrical Manhole	Invert Level	Fuel Bowser	Underground Filler	Arrow Merge	Bench Seating	Waterways Cross Section		
Meter Box	Overt Level	Underground Filler	Diesel Tank	Painted Lettering On Seal	Handrail	Waterways Cross Section		
Power Meter Box	Flood Level	Oil Main Marker	Security Post	Painted Bicycle Traffic Signal Detector	Barrier Concrete	Waterways Cross Section		
Electrical Transformer	Water Line	Tank	Drainage Manhole	Guardrail - W Beam	Barrier Steel Rope	Waterways Cross Section		
MRWA Light Pole	Flood Level Indicator	Drainage Gully	Drainage Headwall	Guardrail - Thrie	Barrier - Single Rail	Waterways Cross Section		
MRWA Multiple Light Pole	Storm Water Grate	Drainage Manhole		Barrier - Double Rail	Barrier - Double Rail	Waterways Cross Section		
	Drainage Gully			Barrier - Triple Rail	Barrier - Triple Rail	Waterways Cross Section		
	Drainage Headwall			Bridge Barrier - (All Types)	Bridge Barrier - (All Types)	Waterways Cross Section		
				Bridge Expansion Joints	Bridge Expansion Joints	Waterways Cross Section		
				Bridge - Outside Of Deck	Bridge - Outside Of Deck	Waterways Cross Section		
				Soffit String	Soffit String	Waterways Cross Section		

Rev.	Description	Drawn	Date	Checked
C	Underground NBN Fibre Added	SAH	12/03/2018	MNG
B	Feature Codes Revised	SAH	22/08/2017	MNG
A	Initial Issue	SAH	30/06/2016	MNG

SCALE 1:1000 @ A3  
  
 ALL DISTANCES ARE IN METRES  
 For a true to scale reproduction of this plan, plot it to A3 with the Pacing Scaling set to None.

The contents of this plan are current and correct as of the date stated within the revision panel. All consultants and persons wishing to utilize this data should satisfy themselves of this plan currency by contacting the McMullen Nolan Group.

Surveyor:- MNG  
 Survey Date:- 22/08/2017  
 Precal/Cad:- N/A

ISO 9001 Quality Management  
 AS/NZS 4801:2001 Occupational Health and Safety Management  
 FS 565311 OSH 591267

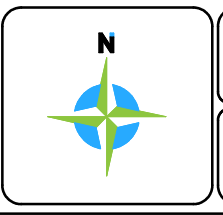

The boundaries shown on this plan were not re-established as part of this survey, therefore this plan does not guarantee their accuracy. Existing easements, encumbrance or interest are not depicted and a title search is recommended to obtain this information. Re-establishment of the cadastral boundaries is recommended for any proposed works on or near existing boundaries.

**MCMULLEN NOLAN GROUP**  
 Level 1, 2 Sabre Crescent  
 Jandakot, W.A. 6164  
 PO Box 3526, Success  
 W.A. 6964, Australia  
 Offices in: Broome, Bunbury, Kununurra, Newman, Port Hedland

Tel: (08) 6436 1599  
 Fax: (08) 6436 1500  
 info@mngsurvey.com.au  
 www.mngsurvey.com.au  
 ABN 90 009 363 311

**MCMULLEN NOLAN GROUP**  
**FEATURE SURVEY - GENERAL LEGEND**

CLIENT: N/A

Project Mng: MNG Datum:

**95465 - DE - 012**  
 Job Number Type Plan Number

25-Jul-2019

208-5