

# APPENDIX C LANDSCAPE PLANS

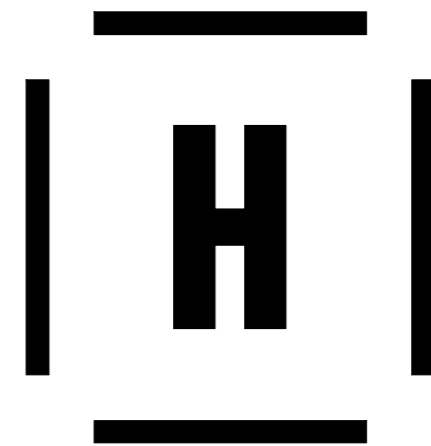



SHEET LIST LANDSCAPE_DA				
Sheet Number	Sheet Name	Current Revision	Current Revision Date	Current Revision Description
SPF-HSLA-00-480-000	COVER SHEET	C	09/03/2023	ISSUED FOR DA
SPF-HSLA-00-480-001	LEGEND - NOTES	B	09/03/2023	ISSUED FOR DA
SPF-HSLA-00-480-002	EXISTING CONDITION PLAN	B	09/03/2023	ISSUED FOR DA
SPF-HSLA-00-480-003	PRECINCT PLAN	B	09/03/2023	ISSUED FOR DA
SPF-HSLA-00-480-004	GENERAL ARRANGEMENT AND SET-OUT	B	09/03/2023	ISSUED FOR DA
SPF-HSLA-00-480-005	GENERAL ARRANGEMENT AND SET-OUT	B	09/03/2023	ISSUED FOR DA
SPF-HSLA-00-480-006	GENERAL ARRANGEMENT AND SET-OUT	B	09/03/2023	ISSUED FOR DA
SPF-HSLA-00-480-007	GENERAL ARRANGEMENT AND SET-OUT	B	09/03/2023	ISSUED FOR DA
SPF-HSLA-00-480-008	DETAIL PLANS	B	09/03/2023	ISSUED FOR DA
SPF-HSLA-00-480-009	PLANTING PLANS - SCHEDULE	B	09/03/2023	ISSUED FOR DA
SPF-HSLA-00-480-010	PLANTING PLANS	B	09/03/2023	ISSUED FOR DA
SPF-HSLA-00-480-011	PLANTING PLANS	B	09/03/2023	ISSUED FOR DA
SPF-HSLA-00-480-012	PLANTING PLANS	B	09/03/2023	ISSUED FOR DA
SPF-HSLA-00-480-013	PLANTING PLANS	B	09/03/2023	ISSUED FOR DA
SPF-HSLA-00-480-014	TYPICAL SECTIONS	B	09/03/2023	ISSUED FOR DA
SPF-HSLA-00-480-015	TYPICAL SECTIONS	B	09/03/2023	ISSUED FOR DA
SPF-HSLA-00-480-016	WALL DETAILS	B	09/03/2023	ISSUED FOR DA

REFERENCE MAP NORTH

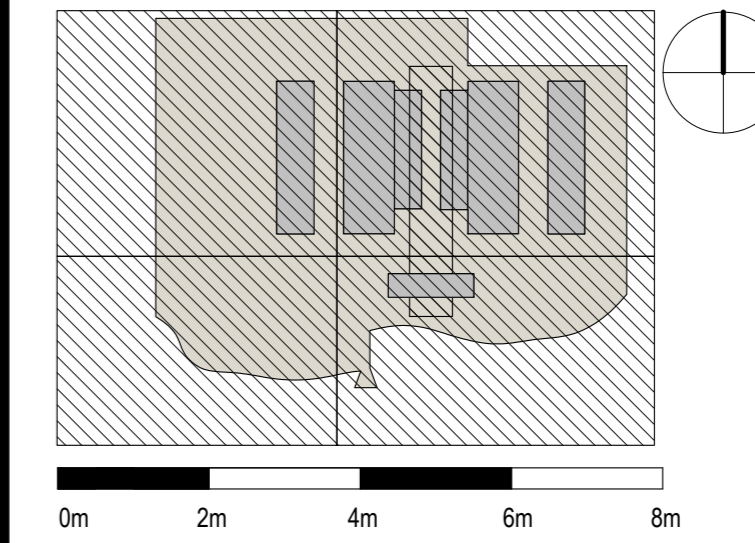

NOTES

1. Do not scale drawing. Written dimensions govern
  2. All dimensions are in millimeters unless noted otherwise
  3. All dimensions shall be verified on site before proceeding with the work. Hassell shall be notified in writing of any discrepancies.
  4. This drawing must be read in conjunction with all relevant contracts, specifications and drawings.
- This drawing is an uncontrolled copy. Unless noted otherwise  
© Copyright of this drawing is vested in Hassell Ltd.

REV	DESCRIPTION	DATE
A	ISSUED FOR DA	09/03/2023
B	ISSUED FOR DA	09/03/2023
C	ISSUED FOR DA	09/03/2023

CONSULTANT

**Hassell** Hassell LTD ABN 24 007 711 435  
Level 11  
Commonwealth Bank Building  
242 Murray Street  
Perth WA 6000 Australia  
T +61 8 9477 8000  
perth@hassellstudio.com

CLIENT

HOME FIRE CREATIVE INDUSTRIES

PROJECT

SCREEN PRODUCTION FACILITY

MALAGA

STATUS

DEVELOPMENT APPLICATION

DRAWING TITLE

COVER SHEET

REVIEWED

NB

SCALE @ A1

APPROVED

NB

PROJECT NO.

015195

DRAWING NO.

SPF-HSLA-00-480-000

REV NO.

C



**LEGEND**

**GENERAL**

CODE	SYMBOL	DESCRIPTION	REFERENCE
		LOT BOUNDARY	
		LANDSCAPE EXTENT OF WORKS	
		MATCHLINES	
		SURVEY	
		CIVIL WORKS	
		DESIGN CONTOUR	REFER CIVIL ENGINEER'S DOCUMENTATION FOR DETAILED SITE LEVELS AND GRADING INFORMATION
		EXISTING CONTOUR	

**LST: PAVING**

CODE	SYMBOL	DESCRIPTION	REFERENCE
LST-001		BLACK ASPHALT	REFER CIVIL ENGINEER'S DOCUMENTATION
LST-002		UNIT PAVING - 300x600x60mm GREY CONCRETE WITH RECYCLED GLASS AGGREGATE	
LST-003		INSITU CONCRETE PAVING (GREY) REFER CIVIL ENGINEER FOR SLAB THICKNESS	
LST-004		PAINTED ASPHALT STREETBOND APPLIED TO LST-001 ASPHALT	
LST-005		TACTILES CONCRETE 300x300mm PAVER TO MEET AUS STANDARDS 1428.4.1	
LST-006		LIMESTONE ROCK PITCHING 150-300MM ROCK, REFER CIVIL ENGINEER	
LST-007		CRUSHED COMPACTED LIMESTONE NOM. 100mm DEPTH	REFER CIVIL ENGINEER'S DOCUMENTATION
LST-008		RECYCLED BASECOURSE	REFER CIVIL ENGINEER'S DOCUMENTATION

**LMI: MISCELLANEOUS ITEMS**

CODE	SYMBOL	DESCRIPTION	REFERENCE
LMI-001		GEOWEB BATTER STABILISATION	SUBJECT TO FINALISATION OF BIOFILTER BASIN IN COORDINATION WITH CIVIL ENGINEER & HYDRAULIC CONSULTANT
LMI-002		ROOT BARRIER	REFER SPECIFICATION & TYPICAL DETAIL
LMI-003		IMPORTED TOP SOIL	REFER SPECIFICATION
LMI-004		SOIL CONDITIONER	REFER SPECIFICATION
LMI-005		FILTER MEDIA	REFER SPECIFICATION
LMI-006		STRUCTURAL CELLS	REFER SPECIFICATION

**LVE: SOFT LANDSCAPE**

CODE	SYMBOL	DESCRIPTION	REFERENCE
LVE-001		IRRIGATED GARDEN BED - ROCK MULCH IMPORTED TOPSOIL, WHERE REQUIRED, OR IMPORTED SOIL CONDITIONER TO AS 4419 100MM DEEP GRAVEL MULCH (10-20mm DIA. NO FINES)	
LVE-002		IRRIGATED GARDEN BED - ORGANIC MULCH IMPORTED TOPSOIL, WHERE REQUIRED, OR IMPORTED SOIL CONDITIONER TO AS 4419 100MM DEEP GRAVEL MULCH (10-20mm DIA. NO FINES)	
LVE-003		IRRIGATED GARDEN BED - BIOSWALE INCLUDING IMPORTED BIOFILTER MEDIA & FILTER LAYERS, BANK STABILISATION AS REQUIRED & 50mm DEEP GRAVEL (10-20mm DIA. NO FINES)	
LVE-004		NON-IRRIGATED PLANTING NO IMPORTED SOIL CONDITIONER, NO IMPORTED MULCH, BIODEGRADABLE TREE & PLANT GUARDS	
LVE-005		NON-IRRIGATED SWALE PLANTING NO IMPORTED SOIL CONDITIONER, NO IMPORTED MULCH, BIODEGRADABLE TREE & PLANT GUARDS	
LVE-010		LAWN (IRRIGATED)	

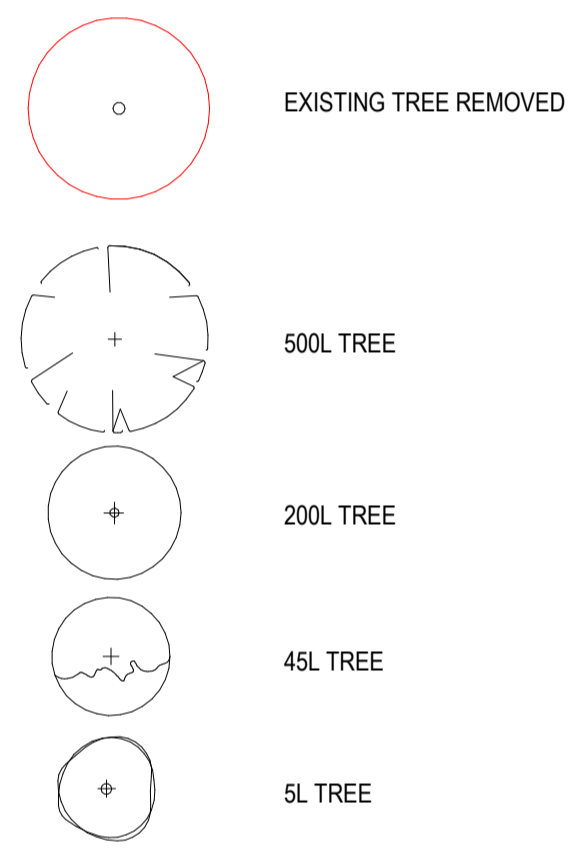

**LWALFE: WALLS AND EDGING**

CODE	SYMBOL	DESCRIPTION	REFERENCE
LWA-001		MIN. 450mm HIGH INSITU CONCRETE SEATING WALL OFF-FORM (TIMBER BOARD) FINISH	
LFE-001		PROPRIETARY 2.4M HIGH BLACK POWDERCOAT GARRISON FENCE STEEL FRAME & SUPPORTS COLOUR: BLACK	
LFE-002		PROPRIETARY GATE INTEGRATED INTO LFE-001 GARRISON FENCE STEEL FRAME & SUPPORTS COLOUR: BLACK	

**LFN: FURNITURE**

CODE	SYMBOL	DESCRIPTION	REFERENCE
LFN-001		TREE SURROUND - CAST ALUMINIUM GRATE (1210x1210mm) WITH 2X IN-GROUND UPLIGHTS WITHIN EACH TREE WELL	
LFN-002		LOOSE TABLE AND CHAIRS	
LFN-003		FIXED PICNIC TABLE SETTING 1565x1820x780mm STEEL & TIMBER CSA ODYSSEE PICNIC SETTING OR SIMILAR APPROVED	
LFN-004		RUBBISH & RECYCLING BIN ENCLOSURE 700x800x1100mm POWDERCOATED STEEL	
LFN-005		MOSS ROCK BOULDERS - GRANITE MIN. DIA. 750mm, MAX. DIA. 2000mm	
LFN-006		BOLLARDS - RECYCLED JARRAH OR SIMILAR APPROVED	
LFN-007		BIKE HOOPS - HOG STEEL BY NOVA PRODUCTS OR SIMILAR APPROVED	
LFN-008		BOLLARD LIGHT	NOTE: LIGHT BOLLARD LOCATIONS SHOWN INDICATIVELY. FINAL PLACEMENT & SELECTION SUBJECT TO PROJECT CONSULTANT TEAM COORDINATION.

**ST: STRUCTURE**

CODE	SYMBOL	DESCRIPTION	REFERENCE
ST-01		SHELTER STRUCTURE STEEL FRAME WITH TIMBER SCREENING	REFER INDICATIVE INTENT BELOW



ST-01 SHELTER STRUCTURE ELEMENTS INCLUDE:  
STEEL FRAME  
CORRUGATED POLYCARBONATE ROOFING  
TIMBER BATTEN CLADDING TO ROOF AND SCREENING

**SYMBOLGY**

CODE	SYMBOL	DESCRIPTION	REFERENCE
01 A1010		DRAWING TITLE	VIEW NUMBER SHEET REFERENCE
00		DRAWING TITLE	SCALE
10 A1010		EXTERIOR	
01		SECTION VIEW NUMBER	SECTION
01 A101		QUALIFY DETAILS: Typ. TYPICAL SIM SIMILAR CALLOUT VIEW CALLOUT REFERENCE SHEET	CALLOUT
01 A101		NORTH SIGNS	
0		SCALE BAR	
0		SETOUT MARKER	
0		GRID MARKER	
100.000 RL L01		LEVEL VALUE LEVEL NUMBER	LEVEL MARKER
100.000		PLAN LEVEL MARKER	
		STEP SETDOWN MARKER	
RL 0.000		SPOT ELEVATION	
CON-01		WALL	
PA-01		SURFACE FINISHES	
CH-01		FURNITURE + EQUIPMENT	
GRAIN		GRAIN MARKER	
CL		CENTRELINE MARKER	
FALL 1:12		BREAK LINE	
		SURFACE FALL	
		RAMPS	
		STAIRS	
		REVISION MARKER	

**REFERENCE MAP**

**NORTH**

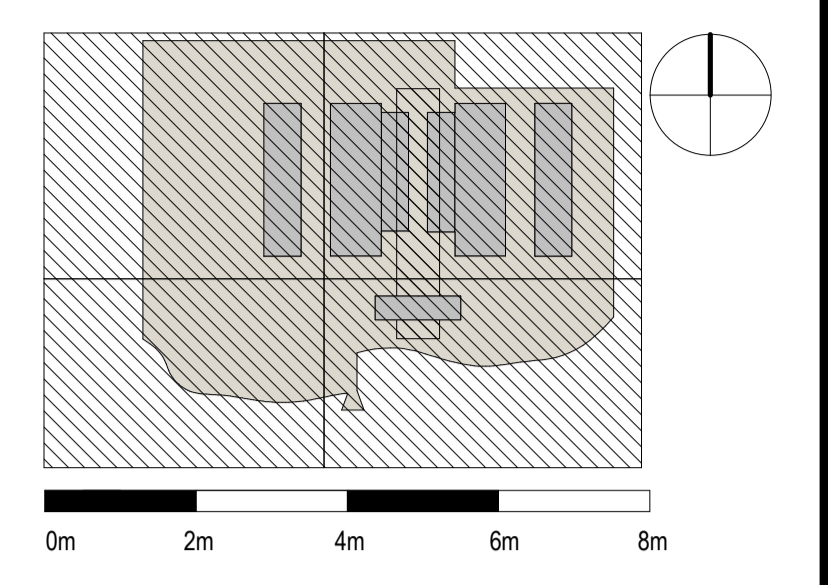

**NOTES**

- Do not scale drawing. Written dimensions govern
- All dimensions are in millimeters unless noted otherwise
- All dimensions shall be verified on site before proceeding with the work. Hassell shall be notified in writing of any discrepancies.
- This drawing must be read in conjunction with all relevant contracts, specifications and drawings  
This drawing is an uncontrolled copy. Unless noted otherwise  
© Copyright of this drawing is vested in Hassell Ltd.

REV	DESCRIPTION	DATE
A	ISSUED FOR DA	09/02/2023
B	ISSUED FOR DA	09/03/2023

**CONSULTANT**



Hassell LTD ABN 24 007 711 435  
Level 1  
Commonwealth Bank Building  
242 Murray Street  
Perth WA 6000 Australia  
T +61 8 6477 6000  
perth@hassellstudio.com

**CLIENT**  
HOME FIRE CREATIVE INDUSTRIES  
**PROJECT**  
SCREEN PRODUCTION FACILITY  
MALAGA

**STATUS**

**DRAWING TITLE**  
LEGEND + NOTES

<b>REVIEWED</b> NB	<b>SCALE @ A1</b> 1 : 50
<b>APPROVED</b> NB	<b>PROJECT NO.</b> 015195
<b>DRAWING NO.</b> SPF-HSL-LA-00-480-001	<b>REV NO.</b> B

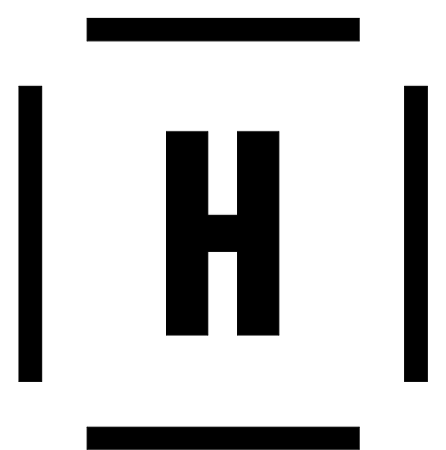

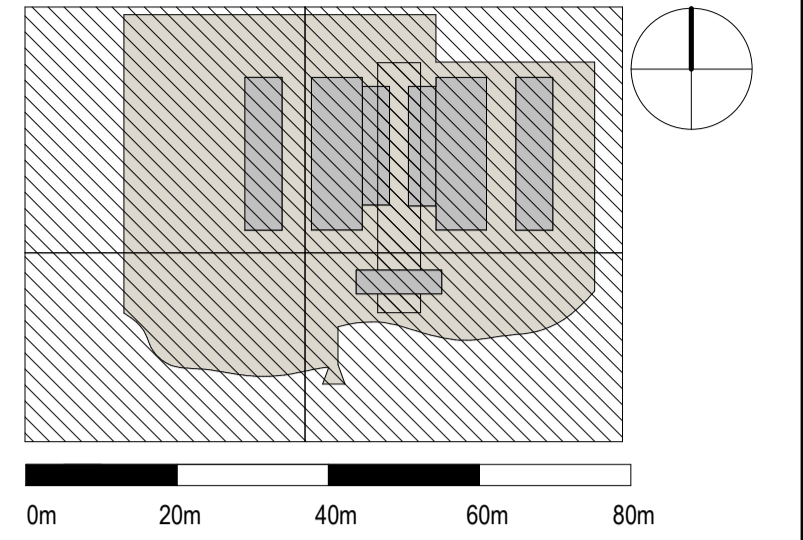

NOTES

1. Do not scale drawing. Written dimensions govern
  2. All dimensions are in millimeters unless noted otherwise
  3. All dimensions shall be verified on site before proceeding with the work. Hassell shall be notified in writing of any discrepancies.
  4. This drawing must be read in conjunction with all relevant contracts, specifications and drawings
- This drawing is an uncontrolled copy. Unless noted otherwise  
© Copyright of this drawing is vested in Hassell Ltd.

REV	DESCRIPTION	DATE
A	ISSUED FOR DA	09/02/2023
B	ISSUED FOR DA	09/03/2023

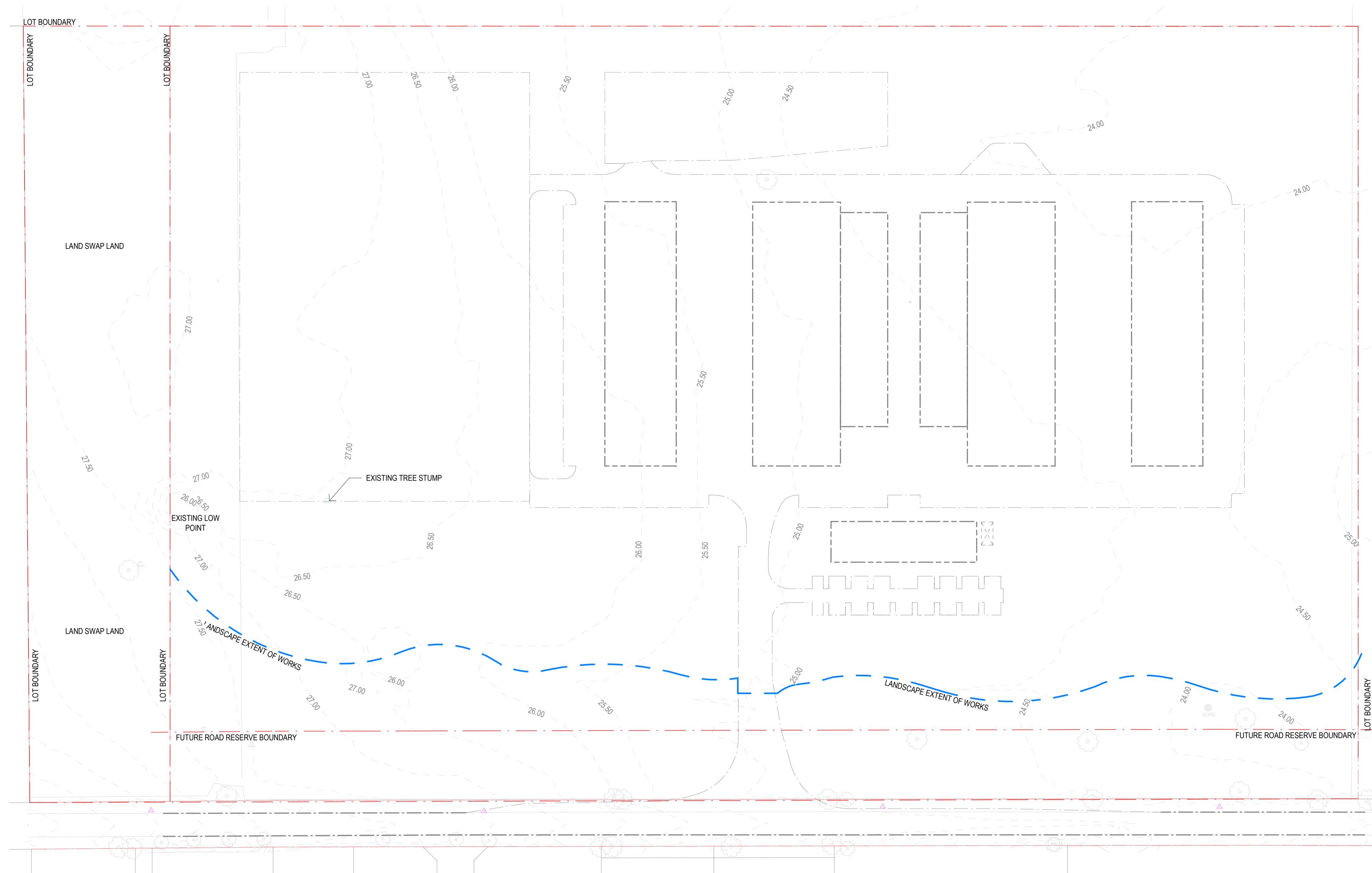

CONSULTANT

**Hassell**

Hassell LTD ABN 24 007 711 435  
Level 1  
Commonwealth Bank Building  
242 Murray Street  
Perth WA 6000 Australia  
T +61 8 6477 6000  
perth@hassellstudio.com

CLIENT

HOME FIRE CREATIVE INDUSTRIES

PROJECT

SCREEN PRODUCTION FACILITY

MALAGA

STATUS

PRELIMINARY

DRAWING TITLE

EXISTING CONDITION PLAN

REVIEWED

NB

SCALE @ A1

1 : 1000

APPROVED

NB

PROJECT NO.

015195

DRAWING NO.

SPF-HSL-LA-00-480-002

REV NO.

B

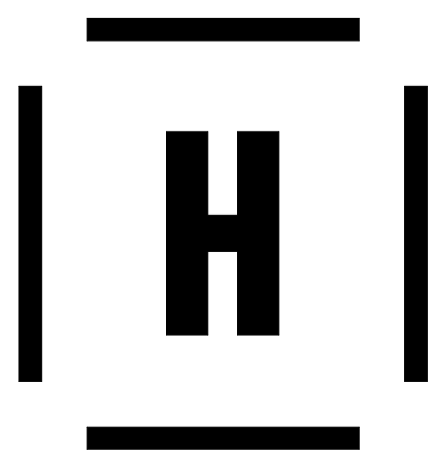



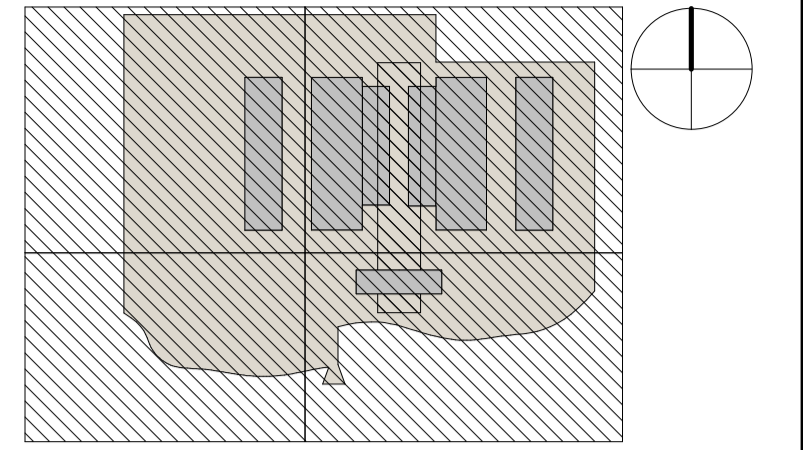

0m 20m 40m 60m 80m

NOTES

1. Do not scale drawing. Written dimensions govern
  2. All dimensions are in millimeters unless noted otherwise
  3. All dimensions shall be verified on site before proceeding with the work. Hassell shall be notified in writing of any discrepancies.
  4. This drawing must be read in conjunction with all relevant contracts, specifications and drawings
- This drawing is an uncontrolled copy. Unless noted otherwise  
© Copyright of this drawing is vested in Hassell Ltd.

REV DESCRIPTION

REV	DESCRIPTION	DATE
A	ISSUED FOR DA	09/02/2023
B	ISSUED FOR DA	09/03/2023

CONSULTANT

**Hassell**

Hassell LTD ABN 24 007 711 435  
Level 1  
Commonwealth Bank Building  
242 Murray Street  
Perth WA 6000 Australia  
T +61 8 6477 6000  
perth@hassellstudio.com

CLIENT

HOME FIRE CREATIVE INDUSTRIES

PROJECT

SCREEN PRODUCTION FACILITY

MALAGA

STATUS

PRELIMINARY

DRAWING TITLE

PRECINCT PLAN

REVIEWED

NB

SCALE @ A1

1 : 1000

APPROVED

NB

PROJECT NO.

015195

DRAWING NO.

SPF-HSL-LA-00-480-003

REV NO.

B

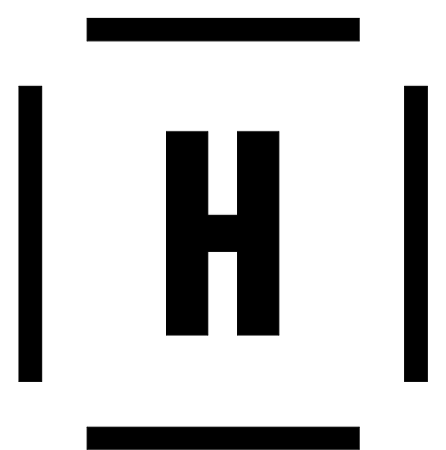
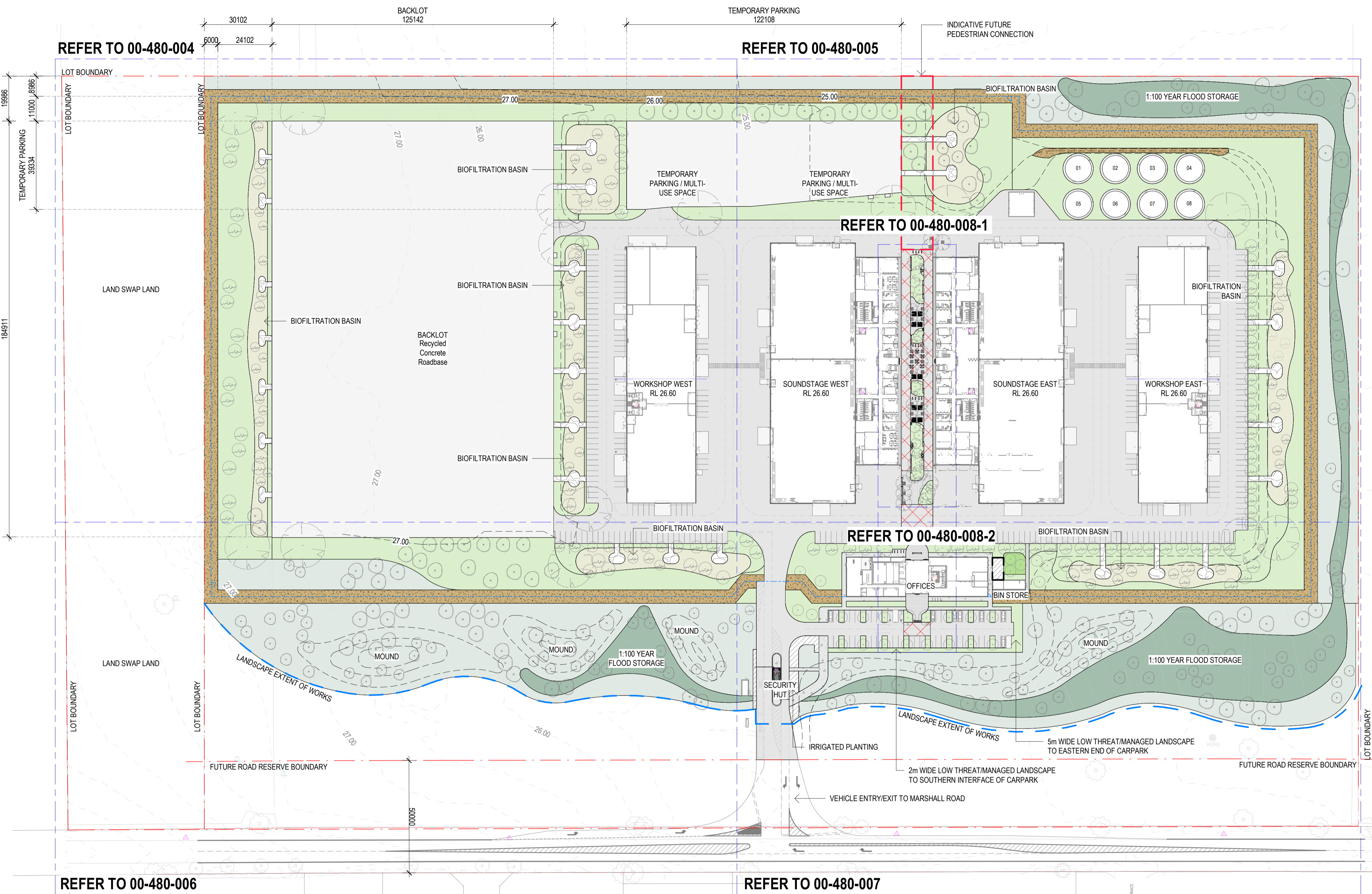







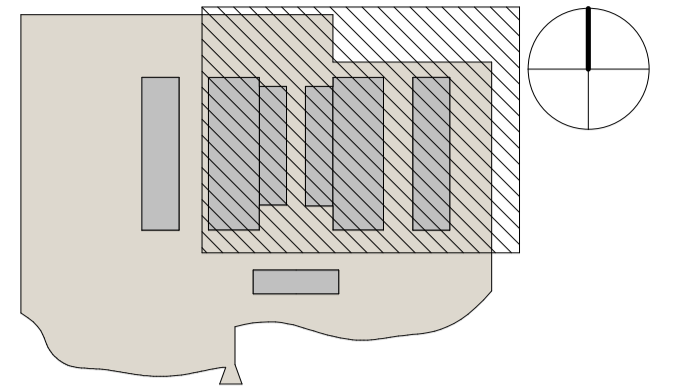

NOTES

1. Do not scale drawing. Written dimensions govern
2. All dimensions are in millimeters unless noted otherwise
3. All dimensions shall be verified on site before proceeding with the work. Hassell shall be notified in writing of any discrepancies.
4. This drawing must be read in conjunction with all relevant contracts, specifications and drawings  
This drawing is an uncontrolled copy. Unless noted otherwise  
© Copyright of this drawing is vested in Hassell Ltd.

REV DESCRIPTION

REV	DESCRIPTION
A	ISSUED FOR DA
B	ISSUED FOR DA

DATE

09/02/2023
09/03/2023

CONSULTANT

**Hassell**

Hassell LTD ABN 24 007 711 435  
Level 1  
Commonwealth Bank Building  
242 Murray Street  
Perth WA 6000 Australia  
T +61 8 6477 6000  
perth@hassellstudio.com

CLIENT

HOME FIRE CREATIVE INDUSTRIES

PROJECT

SCREEN PRODUCTION FACILITY

MALAGA

STATUS

DRAWING TITLE

GENERAL ARRANGEMENT AND SET-OUT

REVIEWED

NB

SCALE @ A1

1 : 500

APPROVED

NB

PROJECT NO.

015195

DRAWING NO.

SPF-HSL-LA-00-480-005

REV NO.

B

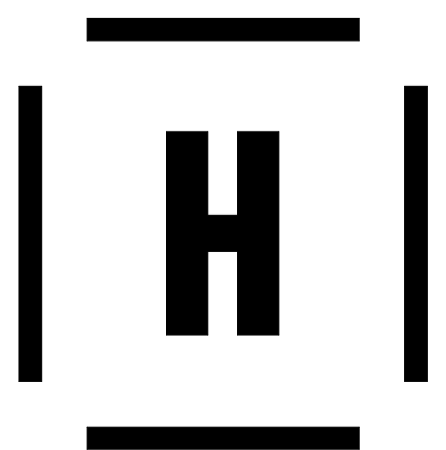
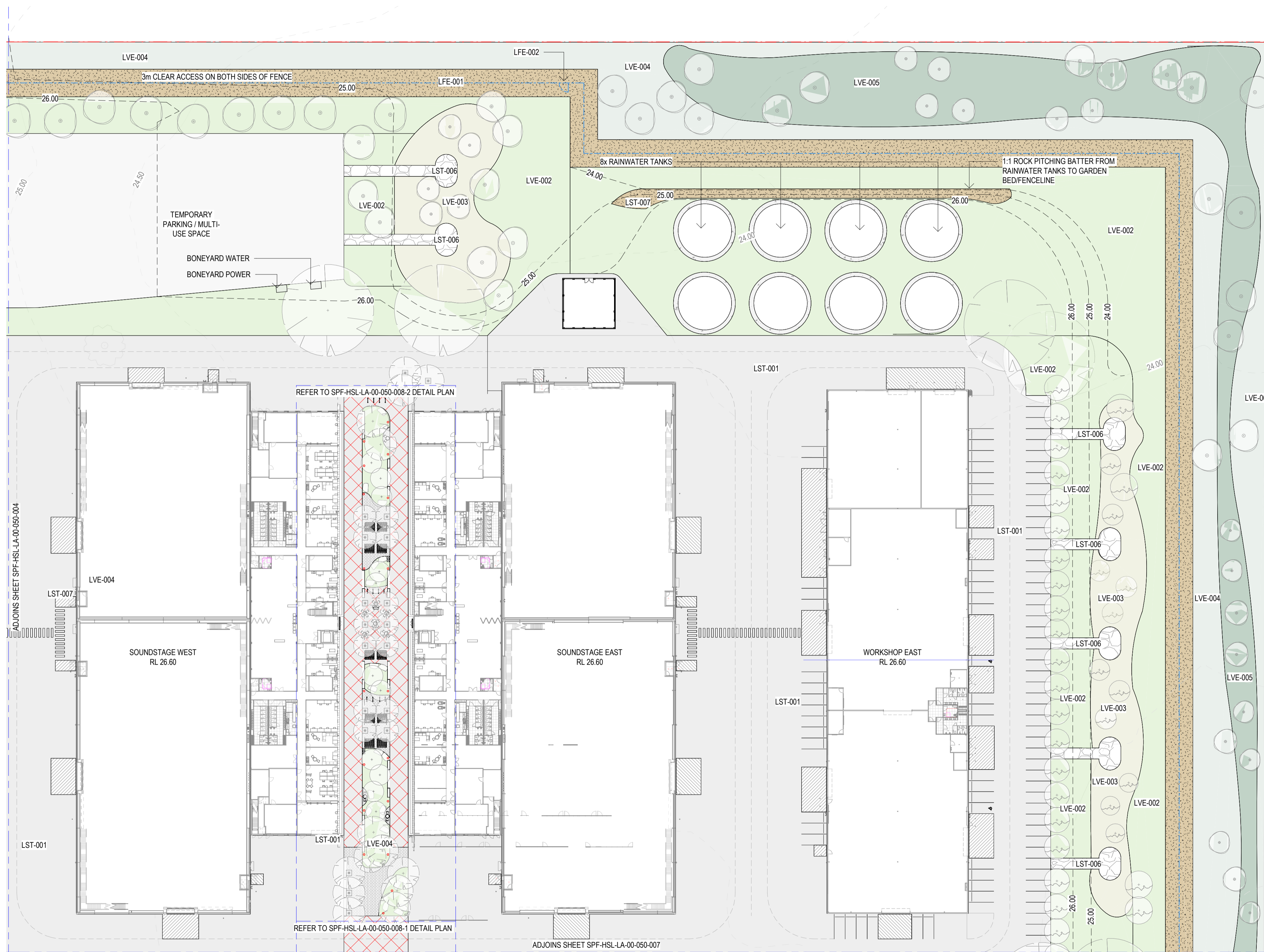



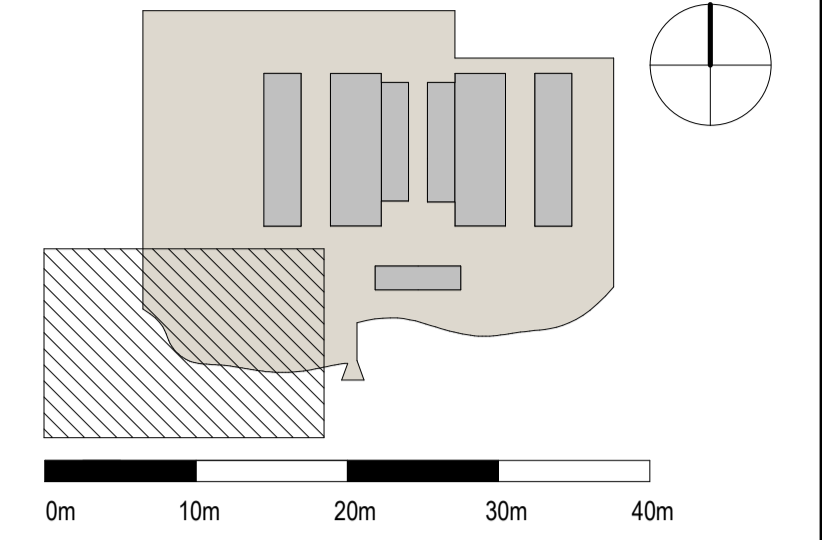

NOTES

1. Do not scale drawing. Written dimensions govern
2. All dimensions are in millimeters unless noted otherwise
3. All dimensions shall be verified on site before proceeding with the work. Hassell shall be notified in writing of any discrepancies.
4. This drawing must be read in conjunction with all relevant contracts, specifications and drawings  
This drawing is an uncontrolled copy. Unless noted otherwise  
© Copyright of this drawing is vested in Hassell Ltd.

REV DESCRIPTION

REV	DESCRIPTION	DATE
A	ISSUED FOR DA	09/02/2023
B	ISSUED FOR DA	09/03/2023

CONSULTANT

**Hassell**

Hassell LTD ABN 24 007 711 435  
Level 1  
Commonwealth Bank Building  
242 Murray Street  
Perth WA 6000 Australia  
T +61 8 6477 6000  
perth@hassellstudio.com

CLIENT

HOME FIRE CREATIVE INDUSTRIES

PROJECT

SCREEN PRODUCTION FACILITY

MALAGA

STATUS

DRAWING TITLE

GENERAL ARRANGEMENT AND SET-OUT

REVIEWED

NB

SCALE @ A1

1 : 500

APPROVED

NB

PROJECT NO.

015195

DRAWING NO.

SPF-HSL-LA-00-480-006

REV NO.

B

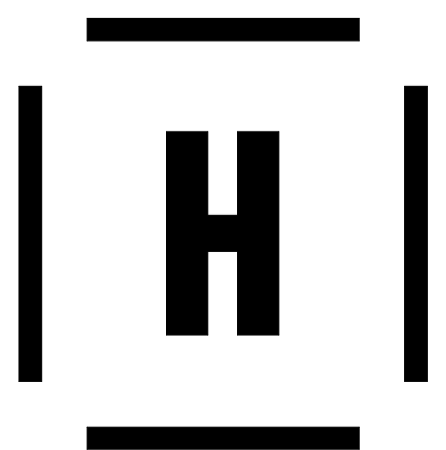
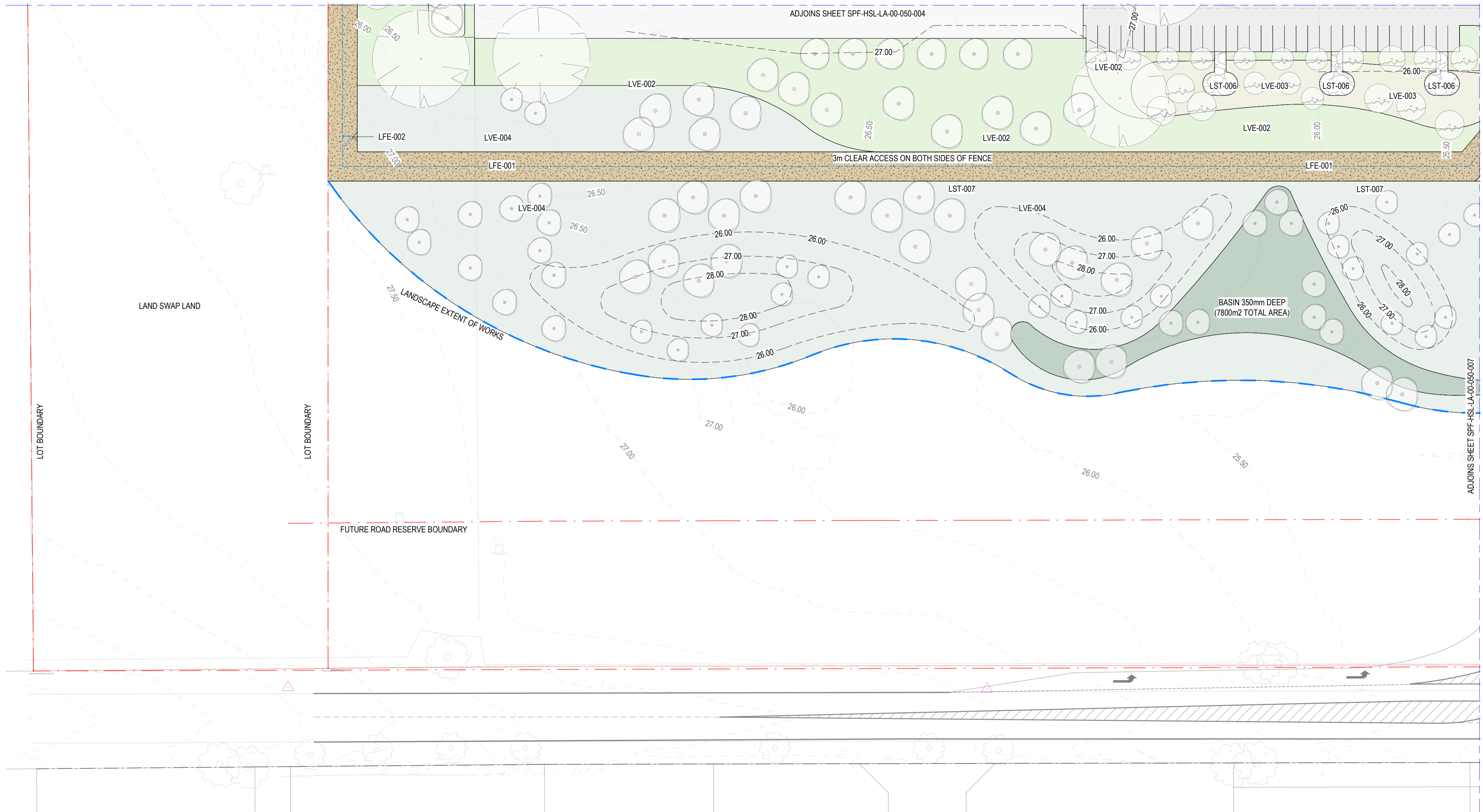



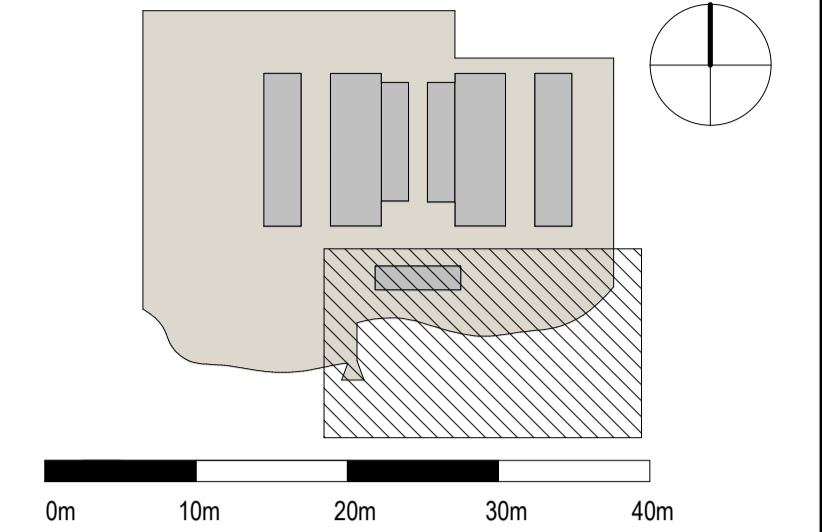

NOTES

1. Do not scale drawing. Written dimensions govern
2. All dimensions are in millimeters unless noted otherwise
3. All dimensions shall be verified on site before proceeding with the work. Hassell shall be notified in writing of any discrepancies.
4. This drawing must be read in conjunction with all relevant contracts, specifications and drawings  
This drawing is an uncontrolled copy. Unless noted otherwise  
© Copyright of this drawing is vested in Hassell Ltd.

REV DESCRIPTION

DATE

A	ISSUED FOR DA	09/02/2023
B	ISSUED FOR DA	09/03/2023

CONSULTANT



Hassell LTD ABN 24 007 711 435  
Level 1  
Commonwealth Bank Building  
242 Murray Street  
Perth WA 6000 Australia  
T +61 8 6477 6000  
perth@hassellstudio.com

CLIENT

HOME FIRE CREATIVE INDUSTRIES

PROJECT

SCREEN PRODUCTION FACILITY

MALAGA

STATUS

DRAWING TITLE

GENERAL ARRANGEMENT AND SET-OUT

REVIEWED

NB

SCALE @ A1

1 : 500

APPROVED

NB

PROJECT NO.

015195

DRAWING NO.

SPF-HSL-LA-00-480-007

REV NO.

B

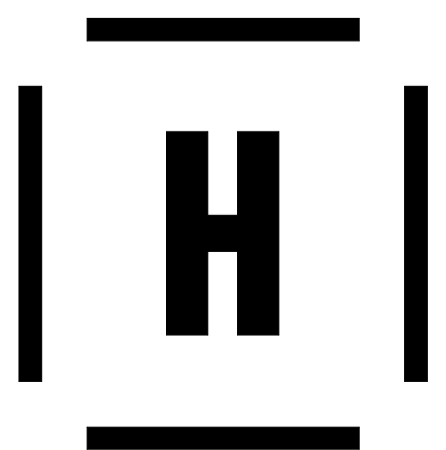
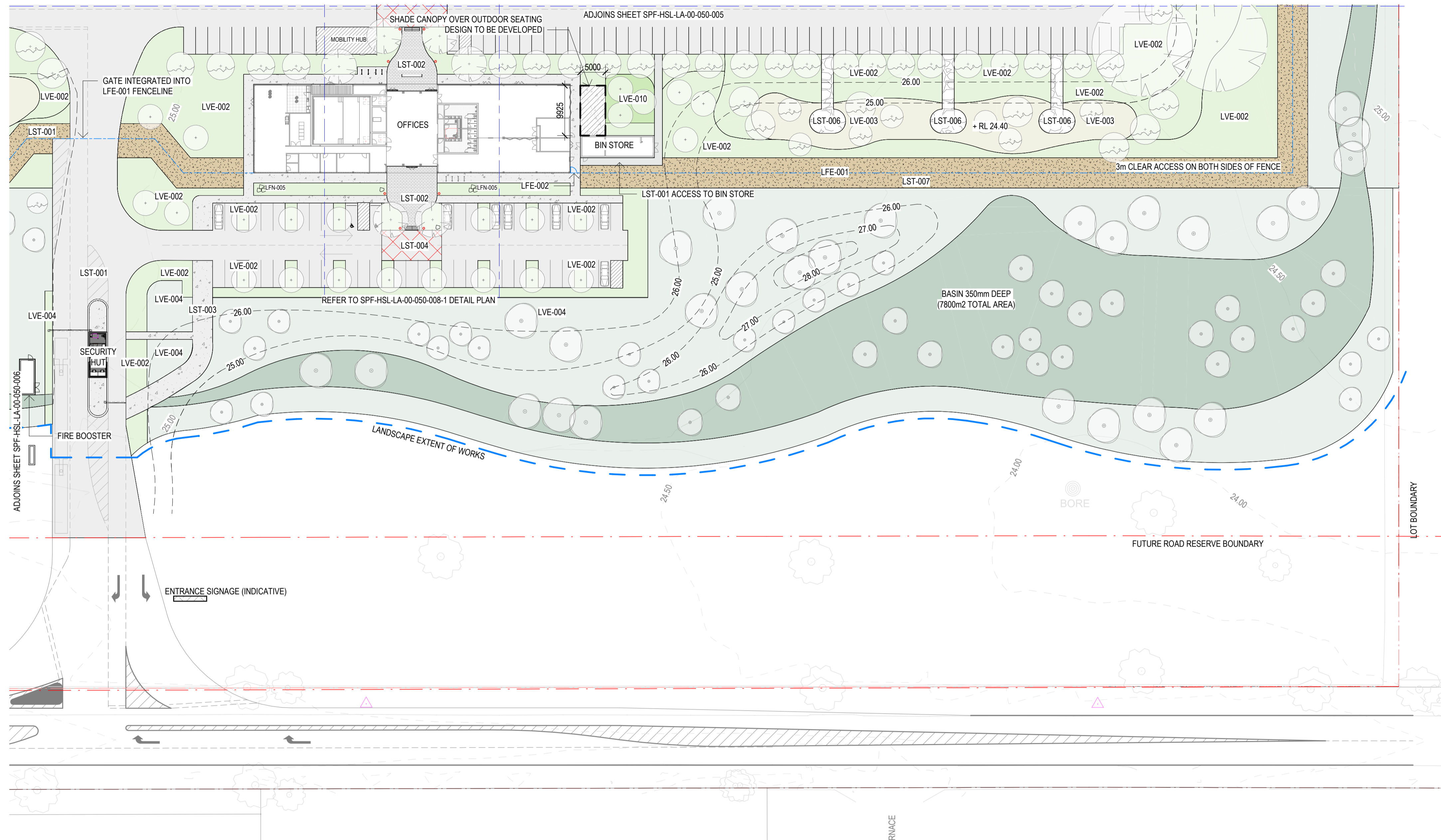







HOMEFIRE LANDSCAPE TREE + PLANT SPECIES LIST

Location	Form	Species	Common Name	Indigenous Name(s)	Mature Size (H x W)	Sun/shade	Flowering season	Flower colour	Plant Complex
<b>IRRIGATED</b> Zone A - Brezeway & Entry Areas	Trees	<i>Banksia attenuata</i>	Candlestick Banksia	Biara	up to 10m	Full Sun	Summer	Yellow	
		<i>Eucalyptus torquata</i>	Coastal Gum	Dwuitta, Maynee, Morf	up to 15m	Full Sun	Summer/Summer	Red/Pink/Coral	
		<i>Eucalyptus totilliana</i>	Coastal Blackbutt		up to 15m	Full Sun	Summer/Autumn	white	
		<i>Eucalyptus vixtrix 'Snow Queen'</i>	Coolibah		up to 8m	Full Sun	Summer/Autumn	white	
		<i>Melaleuca viridiflora</i>	Coolibah		up to 8m	Full Sun	Summer/Autumn	white	
		<i>Acacia pulchella</i>	Prickly Moses		Up to 3m	Full sun	Winter/Spring	Yellow	
		<i>Adenanthos cygnorum</i>	Common Woolly Bush		Up to 4m	Full Sun	NA	NA	
		<i>Adenanthos obovatus</i>	Woolly Bush		1m x 1m W	Full Sun	Spring/ Summer	red/orange	
		<i>Adenanthos cuneatus</i>	Coral Carpet		1m x 1m W	Full Sun	Spring/ Summer	red/orange	
		<i>Banksia nivea</i>	Honeypot Dryandra	Bulgalla	0.5 x 1.0m W	Full Sun/ Part Shade	Spring	Red/ Orange	
Shrubs	<i>Banksia dallmeyerii</i>	Couch Honeypot	Bulgalla	0.5 x 3.0m W	Full Sun	Winter/Spring	Orange		
	<i>Calyxtrix fraseri</i>	Pink Summer Calyxtrix		1.5m x 1.0 W	Full Sun	Winter/Spring	Pink		
	<i>Calyxtrix flavescens</i>	Yellow Starflower		0.5m x 0.5 W	Full Sun	Summer	Yellow		
	<i>Beaufortia squarrosa</i>	Sand Bottlebush		2m x 2m W	Full Sun	Summer/Autumn	Red/ Orange		
	<i>Callistemon 'Better John'</i>	Bottlebrush		0.8m x 0.8m W	Full Sun/ Part Shade	Spring	Yellow		
	<i>Calothamnus hirsutus</i>	Hairy Claw Flower		1.5m x 1.5m W	Full Sun	Spring	red		
	<i>Hibbertia hypericoides</i>	Yellow Buttercups		1.0m x 1.0m W	Full Sun/ Part Shade	Spring/Summer	Yellow		
	<i>Hypocalymma angustifolium</i>	Pink Flowered Myrtle	Koodgeed, Kudjidi	1.5m x 1.5m W	Full Sun	Winter/Spring	White/Pink		
	<i>Hypocalymma robustum</i>	Swan River Myrtle		1.5m x 1.5m W	Full Sun	Winter/Spring	White/Pink		
	<i>Melaleuca nesophila</i>	Western Tea Myrtle		Up to 3m	Full Sun/ Part Shade	Autumn/Winter	White		
Feature Plants	<i>Westringia hybrid 'Blue Gem'</i>	Native Rosemary		1.5m x 1m W	Full Sun	Spring/Summer/ Winter	White		
	<i>Westringia fruticosa 'Mundi'</i>	Native Rosemary		1.5m x 1m W	Full Sun	Spring/Summer/ Winter	Purple		
	<i>Macrozamia reidii</i>	Zamia Palm	Bayoo, Jeerji	3m x 3m W	Full Sun/ Part Shade	NA	NA		
	<i>Eucalyptus macrocarpa</i>	Mottelcar		Up to 5m	Full sun	Spring/Summer	White/Cream		
	<i>Xanthorrhoea preissii</i>	Grass Tree	Balga, Baaluk, Ballak, Balligar, Baluk, Baluk, Barar, Barlock, Baro, Beera, Paaluk, Paik	Up to 5m	Full sun	Spring/Summer	White/Cream		
	<i>Xanthorrhoea gracilis</i>	Grass/ Grass Tree	Mimidi	Up to 2.0m	Full sun	White/Cream	Spring/Summer		
	<i>Xanthorrhoea brunonis</i>	Grass Tree		Up to 1.5m	Full sun	White/Cream	Winter/Spring		
	<i>Boronia crunellata</i>	Aniseed Boronia		1m x 1m W	Part Shade	Spring/Winter	Pink/Purple		
	<i>Common Donkey Orchid</i>	Common Donkey Orchid		0.5m x 0.5m W	Part Shade	Spring	Yellow		
	<i>Caladenia flava</i>	Cowslip Orchid		0.5m x 0.5m W	Part Shade	Spring	Yellow		
Small Shrubs & Orchids	<i>Chorizanthe dicksonii</i>	Yellow Eyed Flame Pea		0.3 x 0.8m W	Full Sun/ Part Shade	Spring	Red/Yellow		
	<i>Grevillea theilmanniana</i>	Spider Net Grevillea		0.3m x 2m W	Full Sun	Spring/Winter	Blue		
	<i>Lechenaultia babba</i>	Blue Lechenaultia		0.5m x 0.5m W	Full Sun	Spring/Summer	Blue		
	<i>Lechenaultia floribunda</i>	Free Flowering Lechenaultia		0.5m x 0.5m W	Full Sun	Spring/Summer	Blue		
	<i>Dampiera linearis</i>	Wedge Leaved Dampiera		0.3m x 1m W	Full Sun/ Part Shade	Spring/Summer	Blue/Purple		
	<i>Verticordia nitens</i>	Morrison Bush	Kotyeningara	1m x 1m W	Full Sun/ Part Shade	Spring/Summer	Yellow/Orange		
	<i>Verticordia plumosa</i>	Plumed Featherflower		1m x 1m W	Full Sun/ Part Shade	Spring/Summer	Pink/White		
	<i>Verticordia densiflora</i>	Compacted Featherflower		1m x 1m W	Full Sun/ Part Shade	Spring/Summer	Pink/White		
	<i>Angoanthos manglesi</i>	Kangaroo Paw	Kurulbrang	0.9m x 0.9m W	Full Sun	Spring	Red/Green		
	<i>Angoanthos humilis</i>	Kangaroo Paw		0.5m x 0.5m W	Full Sun	Spring	Yellow/Orange		
Herbaceous	<i>Dianella revoluta</i>	Flax Lily	Mangard	1m x 1.5m W	Full Sun/ Part Shade	Spring/ Summer	White		
	<i>Palaersonia occidentalis</i>	Purple Flag		0.5m x 0.5m W	Full Sun/ Part Shade	Spring/ Summer	Blue/ Purple		
	<i>Banksia lewinii</i>	Prostrate Banksia		0.5m x 0.5m W	Full Sun/ Part Shade	Spring	Orange		
	<i>Eremophila glabra 'Kabbari Carpet'</i>	Emu Bush		0.2 x 2.0m W	Full Sun/ Part Shade	Spring/Summer	Orange/Yellow		
	<i>Grevillea obtusifolia 'Gingin Gem'</i>	Spider Flower		0.2 x 2.0m W	Full Sun/ Part Shade	Spring/Summer	Red/Yellow		
	<i>Kennedia prostrata</i>	Coral Vine	Wollong	0.1m x 3m	Full Sun/ Part Shade	Spring	Red		
	<i>Kennedia coccinea</i>	Scarlett Runner		0.1m x 3m	Full Sun/ Part Shade	Spring	Red		
	<i>Myoporum parvifolium (prostrate)</i>	Yareena		0.5m x 2m W	Full Sun/ Part Shade	Spring/Summer	White		
	<i>Prostanthera linearifolia</i>	Prostrate Banksia		0.5m x 0.5m W	Full Sun/ Part Shade	Spring	Orange		
	<i>Eremophila glabra 'Kabbari Carpet'</i>	Emu Bush		0.2 x 2.0m W	Full Sun/ Part Shade	Spring/Summer	Orange/Yellow		

\*\* Denotes species not commonly available commercially.

Location	Form	Species	Common Name	Indigenous Name(s)	Mature Size (H x W)	Sun/shade	Flowering season	Flower colour	Maintenance level
<b>IRRIGATED</b> Zone B - Irrigated Garden bed	Trees	<i>Agnonis flexuosa</i>	Peppermint	Wanil, Wonnow, Wonong, Wannang	up to 10m	Full Sun	Spring/Summer	White	
		<i>Banksia ilicifolia</i>	Holly Leaved Banksia		up to 12m	Full Sun	Spring/Summer	Pink/Yellow	
		<i>Banksia grandis</i>	Bull Banksia	Mungtje, Poolgarla, Mangji, Mungtyhch, Beera	up to 10m	Full Sun	Spring/Summer	Yellow/Green	
		<i>Banksia menziesii</i>	Menzies Banksia	Bulgalla	up to 7m	Full Sun	Autumn/ Winter	Red/Yellow	
		<i>Corymbia calophylla</i>	Marrri	Mari, Mari, Marril, Mamee, Mundup, Nandup, Kurnden, Kardan, Cardau, Gardin, Gnydat, Mathee, Ngera, Ngumbat	Up to 40m	Full Sun	Summer/Autumn	Cream/Pink	
		<i>Eucalyptus marginata</i>	Jarrah	Jarrah, Cherring, Chiaragl, Jarrah, Jarrah, Jeerji, Jerri, Jerri, Jerri, Jeryl, Yarrah	up to 40m	Full Sun	Spring/Summer	white	
		<i>Eucalyptus totilliana</i>	Coastal Blackbutt		up to 15m	Full Sun	Summer/Autumn	white	
		<i>Eucalyptus torquata</i>	Coastal Gum		up to 11m	Full Sun	Spring/Summer	Red/Pink/Coral	
		<i>Adenanthos cygnorum</i>	Common Woolly Bush		4m H	Full Sun	NA	NA	
		<i>Adenanthos obovatus</i>	Woolly Bush		1m x 1m W	Full Sun	Spring/ Summer	red/orange	
Shrubs and Groundcovers	<i>Adenanthos cuneatus</i>	Coral Carpet		1m x 1m W	Full Sun	Spring/ Summer	red/orange		
	<i>Banksia lewinii</i>	Prostrate Banksia		0.5m x 0.5m W	Full Sun	Spring	Orange		
	<i>Beaufortia elegans</i>	Bottlebush		1m x 1m W	Full Sun	Summer/ Autumn	Purple		
	<i>Beaufortia squarrosa</i>	Bottlebush	Buno	2m x 2m W	Full Sun	Summer/ Autumn	Red/ Orange		
	<i>Chorizanthe dicksonii</i>	Yellow Eyed Flame Pea		0.3m x 0.8m W	Full Sun/ Part Shade	Spring	Red/Yellow		
	<i>C. quadrifidus 'clean and green'</i>	Bottlebush		2.5m x 2.5m W	Full Sun/ Part Shade	Spring/ Summer	red		
	<i>Calothamnus hirsutus</i>	Hairy Claw Flower		1.5m x 1.5m W	Full Sun	Spring/ Summer	red		
	<i>Hibbertia hypericoides</i>	Yellow Buttercup		1.5m x 1.5m W	Full Sun	Spring/Summer	Yellow		
	<i>Hibbertia cuneiformis</i>	Guinea Flower		1.5m x 1.5m W	Full Sun/ Part Shade	Spring/Summer	Yellow		
	<i>Grevillea olivacea</i>	Olive Grevillea		3.0m x 3.0m	Full Sun/ Part Shade	Winter/Spring	Red/Orange/Yellow		
Herbaceous	<i>Grevillea theilmanniana</i>	Spider Net Grevillea		0.3m x 2m W	Full Sun	Spring/Winter	Blue		
	<i>Lechenaultia babba</i>	Blue Lechenaultia		0.5m x 0.5m W	Full Sun	Spring/Summer	Blue		
	<i>Lechenaultia floribunda</i>	Free Flowering Lechenaultia		0.5m x 0.5m W	Full Sun	Spring/Summer	Blue		
	<i>Myoporum insulare (prostrate)</i>	Yareena		0.5m x 2m W	Full Sun/ Part Shade	Spring/Summer	White		
	<i>Pimelea ferruginea/rosea</i>	Pink Rice Flower		0.5 x 0.5m W	Full Sun	Spring/Winter	Pink		
	<i>Ricinocarpus tuberculatus 'Pencil'</i>	Wedding Bush		2.5 x 1.5m W	Full Sun	Spring/Winter	White		
	<i>Angoanthos manglesi</i>	Kangaroo Paw		0.9 x 0.9m W	Full Sun	Spring	Red/Green		
	<i>Angoanthos humilis</i>	Kangaroo Paw		0.5m x 0.5m W	Full Sun	Spring	Yellow/Orange		
	<i>Conostylis aculeata</i>	Spiny Cottonhead		0.5m x 0.5m W	Full Sun	Spring	Yellow		
	<i>Conostylis candicans</i>	Grey Cottonhead		0.5m x 0.5m W	Full Sun	Spring	Yellow		
Creepers and Groundcovers	<i>Dianella revoluta</i>	Flax Lily	Mangard	1m x 1.5m W	Full Sun/ Part Shade	Spring/ Summer	White		
	<i>Lomandra tanka</i>	Purple Flag		0.5m x 0.5m W	Full Sun/ Part Shade	Spring/ Summer	Blue/ Purple		
	<i>Palaersonia occidentalis</i>	Purple Flag		0.5m x 0.5m W	Full Sun/ Part Shade	Spring/ Summer	Blue/ Purple		
	<i>Hardenbergia comptoniana</i>	Native Wisteria	Koorla	3m x 3m	Full Sun/ Part Shade	Spring/Winter	Purple		
	<i>Eremophila glabra 'Kabbari Carpet'</i>	Emu Bush		0.2 x 2.0m W	Full Sun/ Part Shade	Spring/Summer	Orange/Yellow		
	<i>Grevillea obtusifolia 'Gingin Gem'</i>	Spider Flower		0.2 x 2.0m W	Full Sun/ Part Shade	Spring/Summer	Red/Yellow		
	<i>Kennedia prostrata</i>	Coral Vine	Wollong	0.1m x 3m	Full Sun/ Part Shade	Spring	Red		
	<i>Kennedia coccinea</i>	Scarlett Runner		0.1m x 3m	Full Sun/ Part Shade	Spring	Red		
	<i>Melaleuca laterita</i>	Robin Red Breast Bush	Mindiyet	0.1m x 3m	Full Sun/ Part Shade	Spring	Red		
	<i>Melaleuca nesophila</i>	Western Tea Myrtle		2.0m x 3m	Full Sun/ Part Shade	Autumn/Winter	White		
Shrubs and Grasses	<i>Melaleuca incana</i>	Grey Honey Myrtle		Up to 5m	Full Sun/ Part Shade	Autumn/Winter	White		
	<i>Baumea juncea</i>	Bare Twigrush	Wuargle, Ngamak, Kuirach	1m x 1m W	Full sun	NA	NA		
	<i>Ficinia nodosa</i>	Knotted Clubrush	Yangtji	0.5m x 0.5m W	Full sun	NA	NA		
	<i>Juncus pallidus</i>	Pale Rush	Tangji	1.2m x 1m W	Full sun	NA	NA		
	<i>Juncus kraussii</i>	Sea Rush		1.2m x 1m W	Full Sun/ Part Shade	NA	NA		
	<i>Lepidosperma effusum</i>	Riverside Sword Sedge		1.2m x 1m W	Full Sun/ Part Shade	NA	NA		
	<i>Lepidosperma longitandiale</i>	Pilly Sword Sedge		2.0m x 0.5m W	Full Sun/ Part Shade	NA	NA		
	<i>Lepidosperma gladiatum</i>	Coast Sword Sedge	Kerbein	1.5m x 0.5m W	Full Sun/ Part Shade	NA	NA		
	<i>Melaleuca incana</i>	Grey Honey Myrtle		Up to 5m	Full Sun/ Part Shade	Autumn/Winter	White		

\* Indicates Western Australian species likely to be effective at nutrient removal

\*\* Indicates Western Australian species tested to be effective at nutrient removal

Location	Form	Species	Common Name	Indigenous Name(s)	Mature Size (H x W)	Sun/shade	Flowering season	Flower colour	Maintenance level
<b>NON IRRIGATED</b> Zone C - Native Planting Zone	Trees	<i>Acacia saligna</i>	Orange Wattle	Cujung	Up to 5m	Full Sun	Spring/Summer	Yellow	
		<i>Allocasuarina fraseriana</i>	Fraser's Sheoak	Kondli	up to 10m	Full Sun/ Part Shade	Spring/Summer	Yellow	
		<i>Banksia grandis</i>	Bull Banksia	Mungtje, Poolgarla, Mangji, Mungtyhch, Beera	up to 10m	Full Sun	Spring/Summer	Yellow/Green	
		<i>Banksia attenuata</i>	Candlestick Banksia	Biara	up to 10m	Full Sun	Summer	Yellow	
		<i>Banksia ilicifolia</i>	Holly Leaved Banksia		up to 12m	Full Sun	Spring/Summer	Pink/Yellow	
		<i>Banksia menziesii</i>	Menzies Banksia	Bulgalla	up to 7m	Full Sun	Autumn/ Winter	Red/Yellow	
		<i>Macrozamia reidii</i>	Zamia Palm	Balga, Baaluk, Ballak, Balligar, Baluk, Baluk, Barar, Barlock, Baro, Beera, Paaluk, Paik	3m x 3m W	Full Sun/ Part Shade	NA	NA	
		<i>Xanthorrhoea preissii</i>	Grass Tree		Up to 5m	Full Sun	Spring/Summer	White/Cream	
		<i>Xanthorrhoea gracilis</i>	Grass Tree	Mimidi	Up to 2.0m	Full sun	White/Cream	Spring/Summer	
		<i>Xanthorrhoea brunonis</i>	Grass Tree		Up to 1.5m	Full sun	White/Cream	Winter/Spring	
Feature Plants	<i>Adenanthos cygnorum</i>	Common Woolly Bush		4m H	Full Sun	NA	NA		
	<i>Adenanthos obovatus</i>	Woolly Bush		1m x 1m W	Full Sun	Spring/ Summer	red/orange		
	<i>Adenanthos cuneatus</i>	Coral Carpet		1m x 1m W	Full Sun	Spring/ Summer	red/orange		
	<i>Acacia rostellata</i>	Summer Scented Wattle		Up to 5m	Full Sun	Winter/Spring	Yellow		
	<i>Acacia lasiocarpa</i>	Dune Moses	Parjang, Pajang	1.5m x 1.0m W	Full Sun	Autumn/Winter	Yellow		
	<i>Banksia lewinii</i>	Prostrate Banksia		0.5m x 0.5m W	Full Sun/ Part Shade	Spring	Orange		
	<i>Beaufortia squarrosa</i>	Sandplains Brush Myrtle		2m x 2m W	Full Sun	Summer/ Autumn	Red/ Orange		
	<i>Boronia crunellata</i>	Aniseed Boronia		1m x 1m W	Part Shade	Spring/Winter	Pink/Purple		
	<i>C. quadrifidus</i>	Yellow Eyed Flame Pea		2.5m x 2.5m W	Full Sun/ Part Shade	Spring/ Summer	red		
	<i>Chamaelucium uncinatum</i>	Geraldton Wax		3.0m x 4.0m W	Full Sun/ Part Shade	Spring/ Summer	White/Pink		
Shrubs and Groundcovers	<i>Chorizanthe dicksonii</i>	Yellow Eyed Flame Pea		0.3m x 0.8m W	Full Sun/ Part Shade	Spring	Red/Yellow		
	<i>Darwinia cinerea</i>	Lemon Scented Myrtle		1.5m x 1.5m W	Full Sun	Spring/Summer	Yellow		
	<i>Eremophila glabra 'Kabbari Carpet'</i>	Emu Bush		0.2 x 2.0m W	Full Sun/ Part Shade	Spring/Summer	Orange/Yellow		
	<i>Grevillea obtusifolia 'Gingin Gem'</i>	Spider Flower		0.2 x 2.0m W	Full Sun/ Part Shade	Spring/Summer	Red/Yellow		
	<i>Grevillea theilmanniana</i>	Spider Net Grevillea		1.0m x 1.0m	Full Sun/ Part Shade	Spring	Yellow		
	<i>Hibbertia hypericoides</i>	Yellow Buttercups		1.0m x 1.0m W	Full Sun/ Part Shade	Spring/Summer	Yellow		
	<i>Hypocalymma angustifolium</i>	Pink Flowered Myrtle	Koodgeed, Kudjidi	1.5m x 1.5m W	Full Sun	Winter/Spring	White/Pink		
	<i>Hypocalymma robustum</i>	Swan River Myrtle		1.5m x 1.5m W	Full Sun	Winter/Spring	White/Pink		
	<i>Melaleuca incana</i>	Grey Honey Myrtle		Up to 5m	Full Sun/ Part Shade	Autumn/Winter	White		
	<i>Regelia cilia</i>	White Bajine		1.0 x 1.0m W	Full Sun	Spring/Summer	Red		
Herbaceous	<i>Anigozanthos manglesi</i>	Kangaroo Paw		0.9 x 0.9m W	Full Sun	Spring	Red/Green		
	<i>Angoanthos humilis</i>	Kangaroo Paw		0.5m x 0.5m W	Full Sun	Spring	Yellow/Orange		
	<i>Conostylis aculeata</i>	Spiny Cottonhead		0.5m x 0.5m W	Full Sun	Spring	Yellow		
	<i>Conostylis candicans</i>	Grey Cottonhead	Mangard	0.5m x 0.5m W	Full Sun	Spring/Winter	Yellow		
	<i>Dianella revoluta</i>	Flax Lily		1m x 1.5m W	Full Sun/ Part Shade	Spring/ Summer	White		



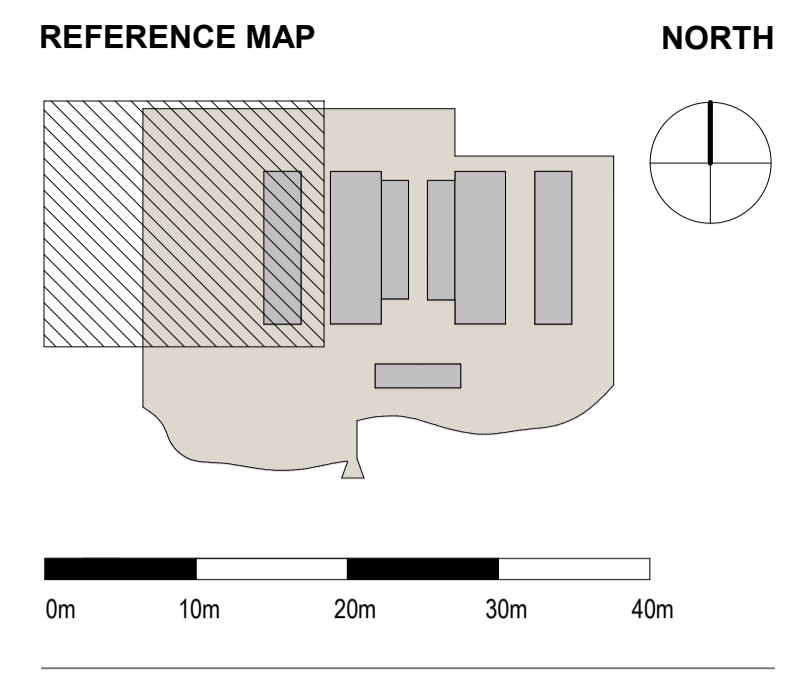
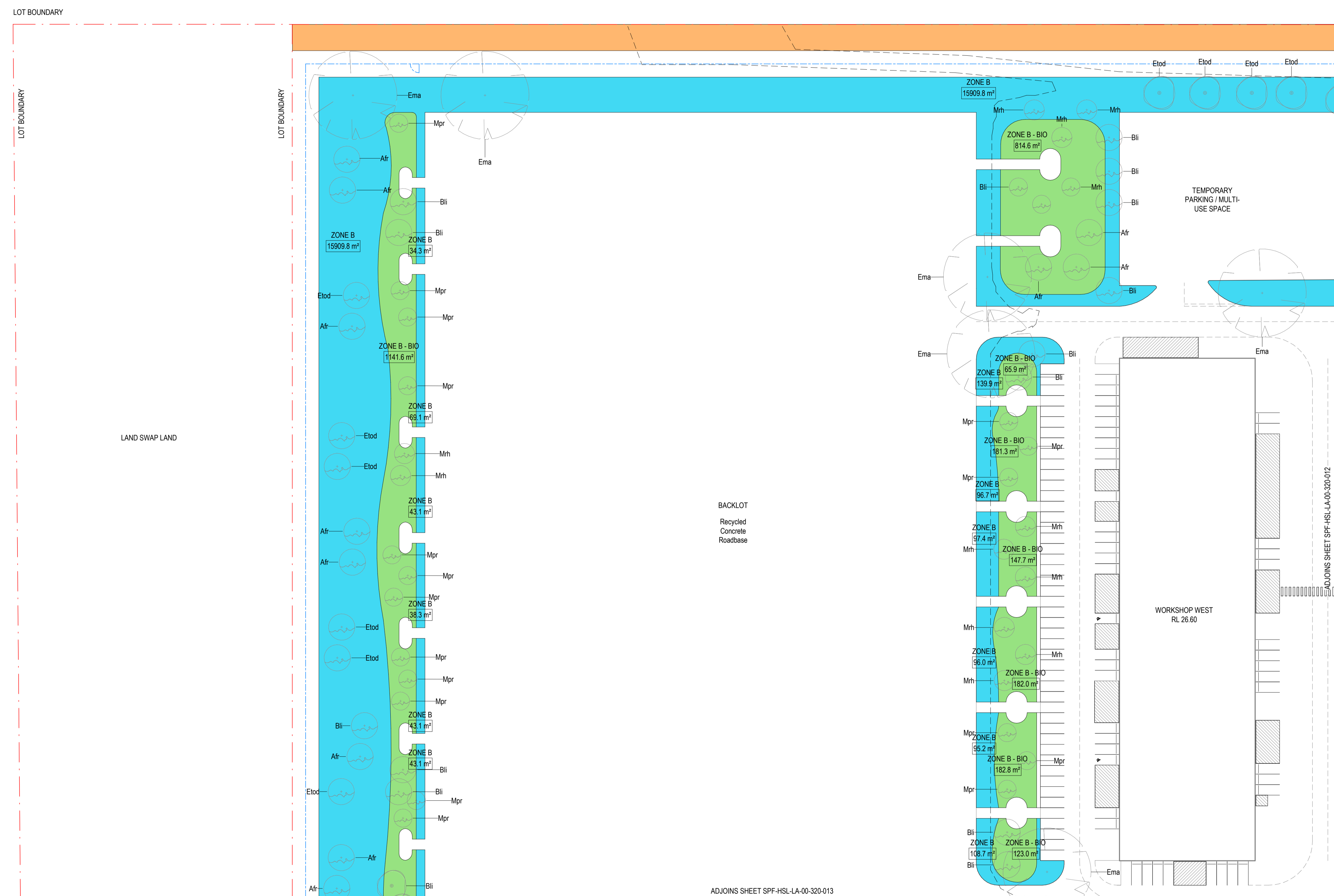
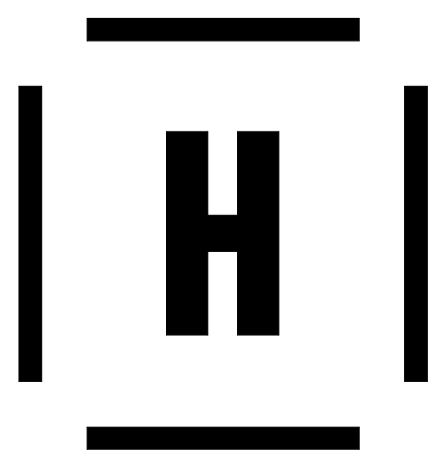

**NOTES**

1. Do not scale drawing. Written dimensions govern
2. All dimensions are in millimeters unless noted otherwise
3. All dimensions shall be verified on site before proceeding with the work. Hassell shall be notified in writing of any discrepancies.
4. This drawing must be read in conjunction with all relevant contracts, specifications and drawings

This drawing is an uncontrolled copy. Unless noted otherwise  
© Copyright of this drawing is vested in Hassell Ltd.

REV	DESCRIPTION	DATE
A	ISSUED FOR DA	09/02/2023
B	ISSUED FOR DA	09/03/2023

**CONSULTANT**

**Hassell**

Hassell LTD ABN 24 007 711 435  
Level 1  
Commonwealth Bank Building  
242 Murray Street  
Perth WA 6000 Australia  
T +61 8 6477 6000  
perth@hassellstudio.com

**CLIENT**

HOME FIRE CREATIVE INDUSTRIES

**PROJECT**

SCREEN PRODUCTION FACILITY  
MALAGA

**STATUS**

**DRAWING TITLE**

PLANTING PLANS

<b>REVIEWED</b> Checker	<b>SCALE @ A1</b> 1 : 500
<b>APPROVED</b> Approver	<b>PROJECT NO.</b> 015195
<b>DRAWING NO.</b> SPF-HSL-LA-00-480-010	<b>REV NO.</b> B



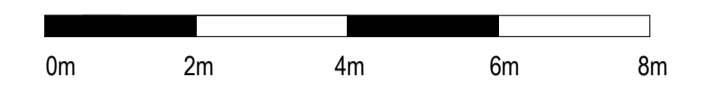
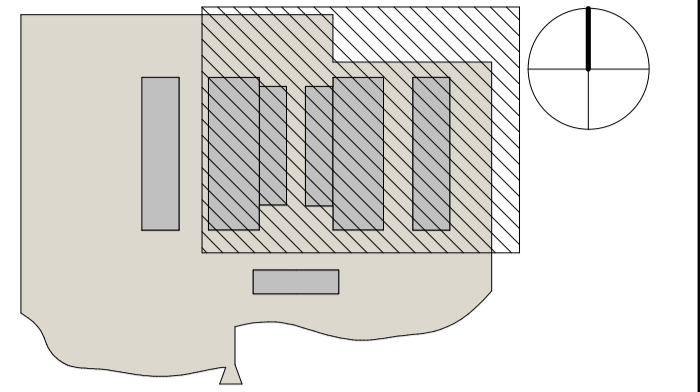

NOTES

1. Do not scale drawing. Written dimensions govern
2. All dimensions are in millimeters unless noted otherwise
3. All dimensions shall be verified on site before proceeding with the work. Hassell shall be notified in writing of any discrepancies.
4. This drawing must be read in conjunction with all relevant contracts, specifications and drawings  
This drawing is an uncontrolled copy. Unless noted otherwise  
© Copyright of this drawing is vested in Hassell Ltd.

REV DESCRIPTION

DATE

A	ISSUED FOR DA	09/02/2023
B	ISSUED FOR DA	09/03/2023

CONSULTANT

**Hassell**

Hassell LTD ABN 24 007 711 435  
Level 1  
Commonwealth Bank Building  
242 Murray Street  
Perth WA 6000 Australia  
T +61 8 6477 6000  
perth@hassellstudio.com

CLIENT

HOME FIRE CREATIVE INDUSTRIES

PROJECT

SCREEN PRODUCTION FACILITY

MALAGA

STATUS

DRAWING TITLE

PLANTING PLANS

REVIEWED

Checker

SCALE @ A1

1 : 500

APPROVED

Approver

PROJECT NO.

015195

DRAWING NO.

SPF-HSL-LA-00-480-011

REV NO.

B

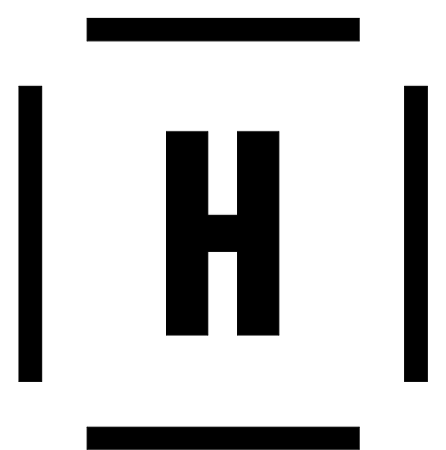
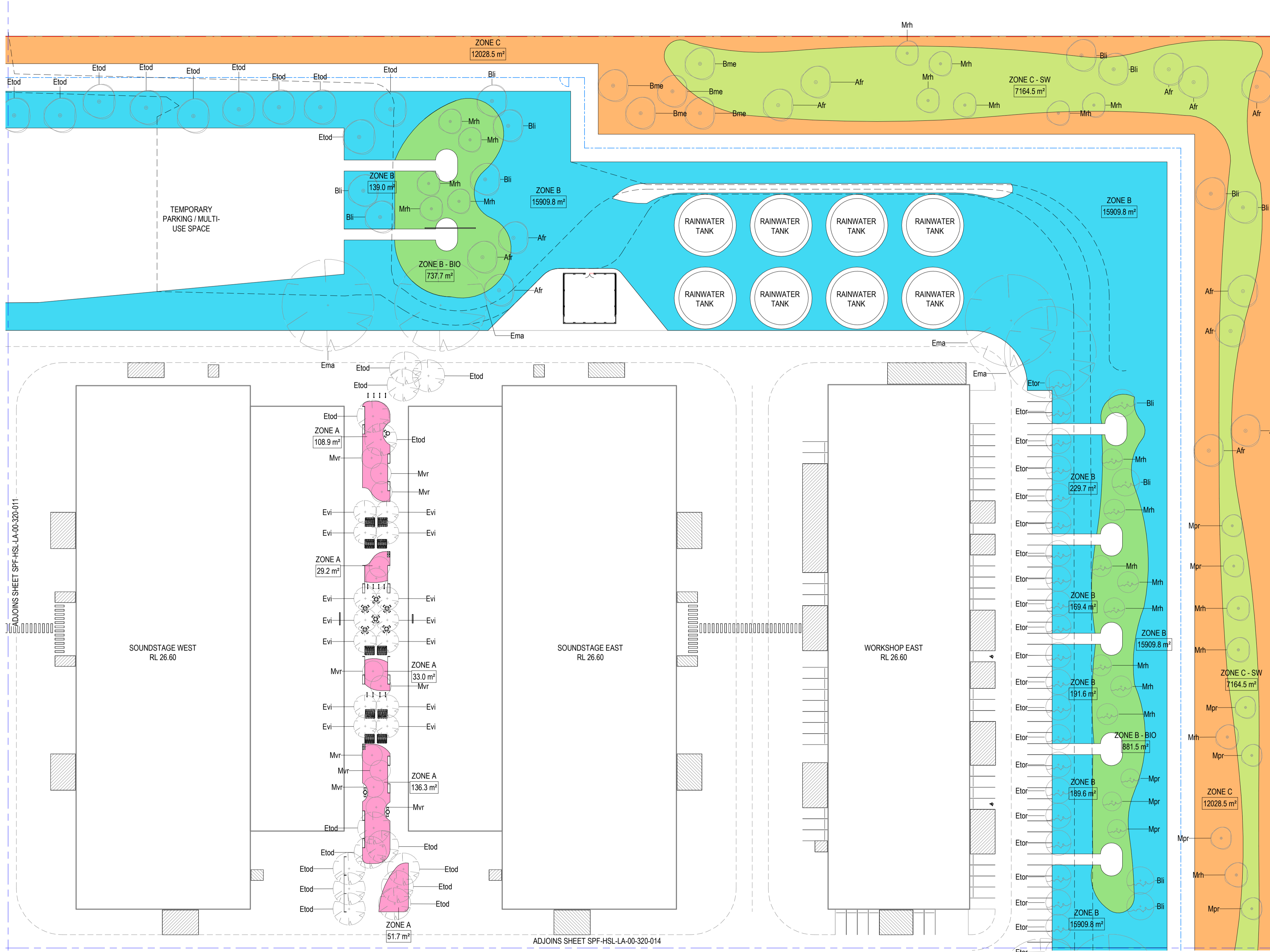

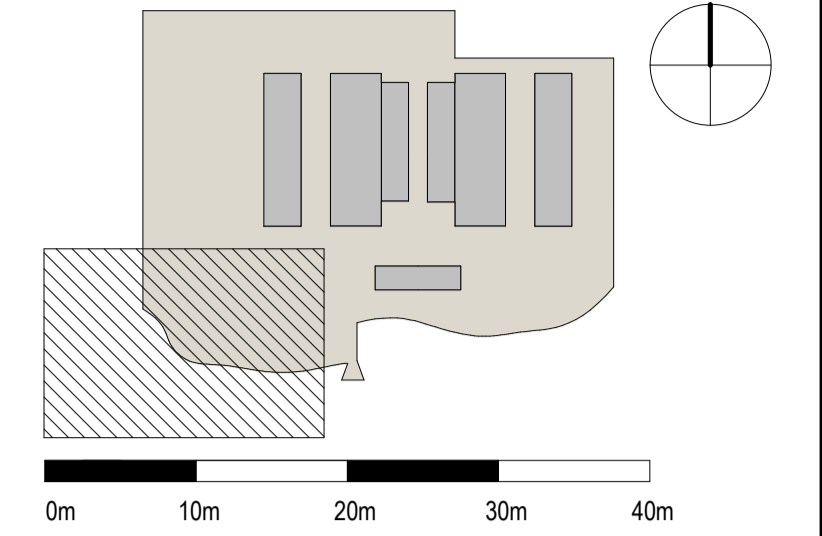

NOTES

1. Do not scale drawing. Written dimensions govern
2. All dimensions are in millimeters unless noted otherwise
3. All dimensions shall be verified on site before proceeding with the work. Hassell shall be notified in writing of any discrepancies.
4. This drawing must be read in conjunction with all relevant contracts, specifications and drawings  
This drawing is an uncontrolled copy. Unless noted otherwise  
© Copyright of this drawing is vested in Hassell Ltd.

REV DESCRIPTION

DATE

A	ISSUED FOR DA	09/02/2023
B	ISSUED FOR DA	09/03/2023

CONSULTANT

**Hassell**

Hassell LTD ABN 24 007 711 435  
Level 1  
Commonwealth Bank Building  
242 Murray Street  
Perth WA 6000 Australia  
T +61 8 6477 6000  
perth@hassellstudio.com

CLIENT

HOME FIRE CREATIVE INDUSTRIES

PROJECT

SCREEN PRODUCTION FACILITY

MALAGA

STATUS

DRAWING TITLE

PLANTING PLANS

REVIEWED

Checker

SCALE @ A1

1 : 500

APPROVED

Approver

PROJECT NO.

015195

DRAWING NO.

SPF-HSL-LA-00-480-012

REV NO.

B

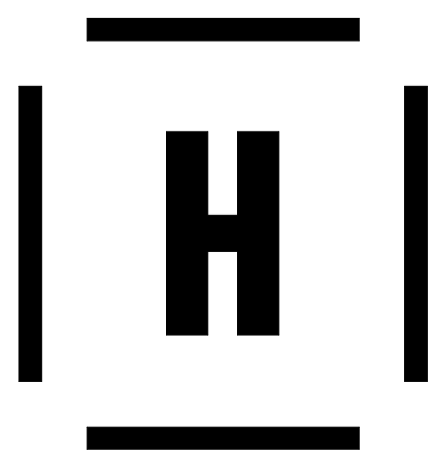
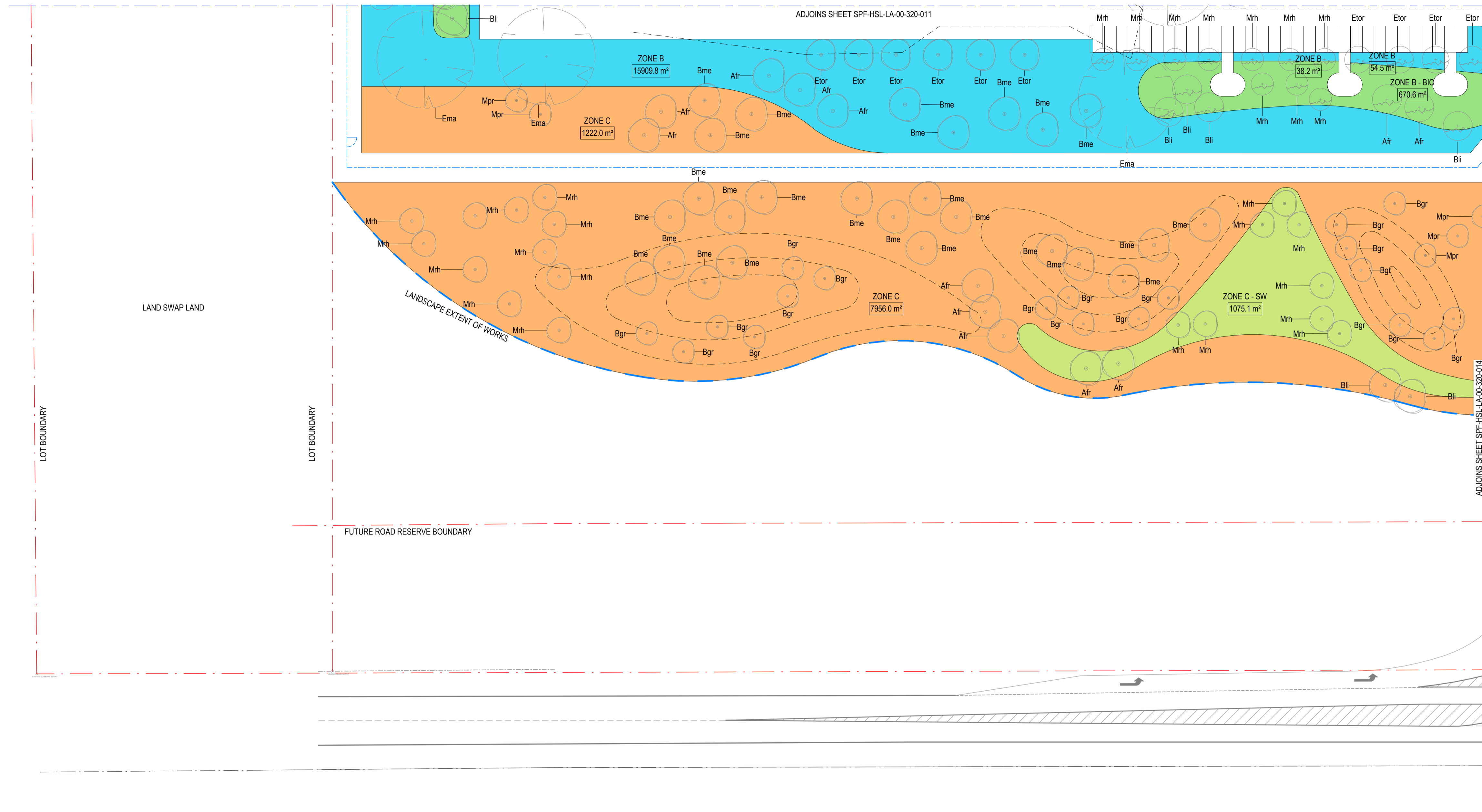







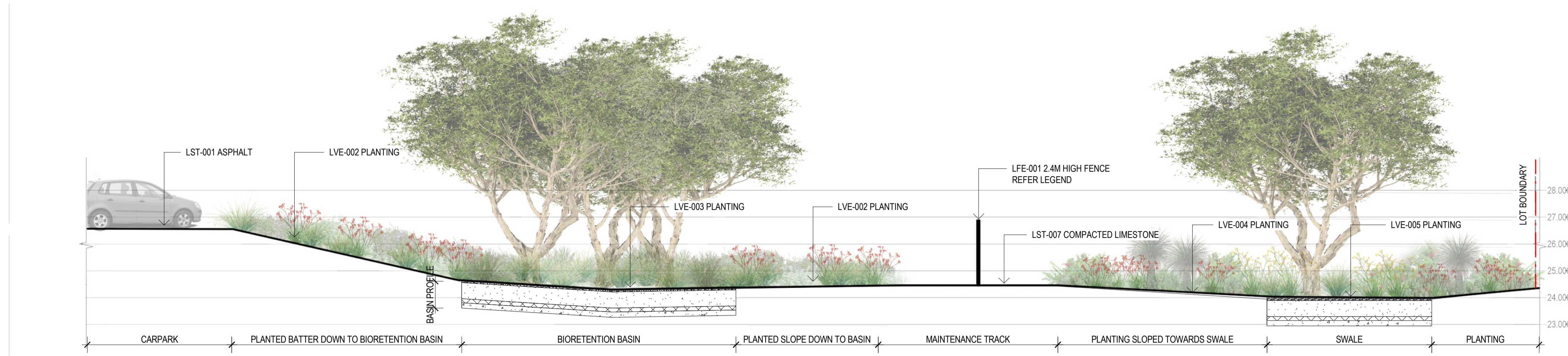

1 EASTERN EDGE INTERFACE  
1:100



2 WESTERN EDGE - BACKLOT INTERFACE  
1:75

REFERENCE MAP NORTH

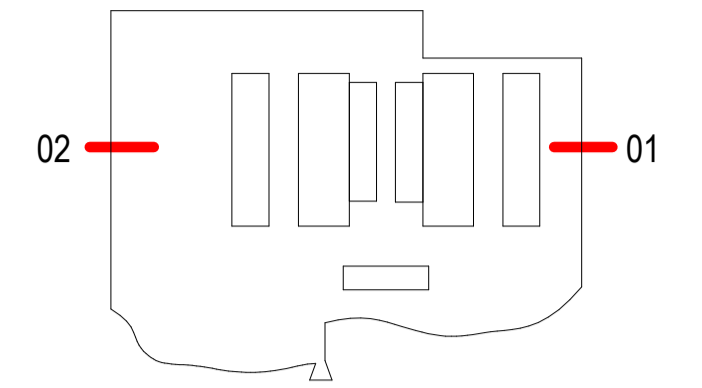

**NOTES**

1. Do not scale drawing. Written dimensions govern
2. All dimensions are in millimeters unless noted otherwise
3. All dimensions shall be verified on site before proceeding with the work. Hassell shall be notified in writing of any discrepancies.
4. This drawing must be read in conjunction with all relevant contracts, specifications and drawings

This drawing is an uncontrolled copy. Unless noted otherwise  
© Copyright of this drawing is vested in Hassell Ltd.

REV	DESCRIPTION	DATE
A	ISSUED FOR DA	09/02/2023
B	ISSUED FOR DA	09/03/2023

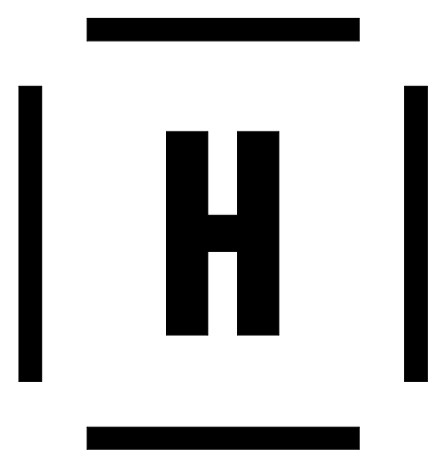

**CONSULTANT**

**Hassell**

Hassell LTD ABN 24 007 711 435  
Level 1  
Commonwealth Bank Building  
242 Murray Street  
Perth WA 6000 Australia  
T +61 8 6477 6000  
perth@hassellstudio.com

**CLIENT**  
HOME FIRE CREATIVE INDUSTRIES

**PROJECT**  
SCREEN PRODUCTION FACILITY  
MALAGA

**STATUS**

**DRAWING TITLE**  
TYPICAL SECTIONS

<b>REVIEWED</b> Checker	<b>SCALE @ A1</b> As indicated
<b>APPROVED</b> Approver	<b>PROJECT NO.</b> 015195
<b>DRAWING NO.</b> SPF-HSL-LA-00-480-014	<b>REV NO.</b> B



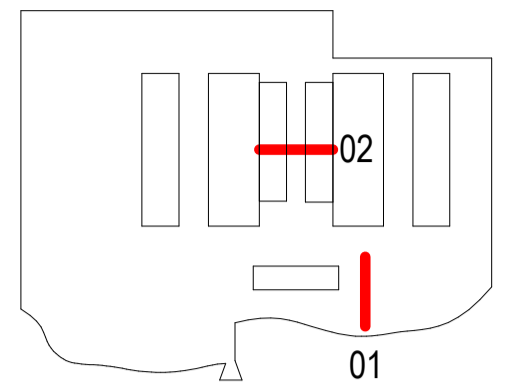

NOTES

1. Do not scale drawing. Written dimensions govern
2. All dimensions are in millimeters unless noted otherwise
3. All dimensions shall be verified on site before proceeding with the work. Hassell shall be notified in writing of any discrepancies.
4. This drawing must be read in conjunction with all relevant contracts, specifications and drawings  
This drawing is an uncontrolled copy. Unless noted otherwise  
© Copyright of this drawing is vested in Hassell Ltd.

REV	DESCRIPTION	DATE
A	ISSUED FOR DA	09/02/2023
B	ISSUED FOR DA	09/03/2023

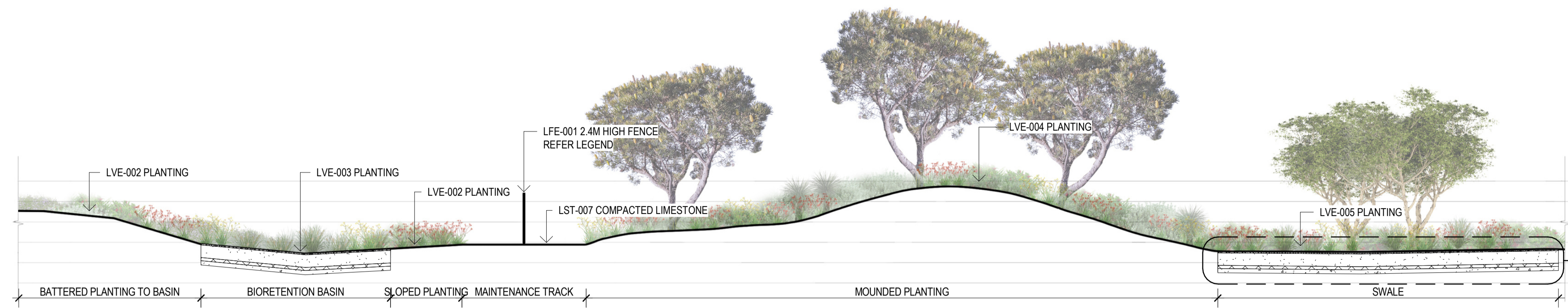

1 SOUTHERN INTERFACE  
1:150

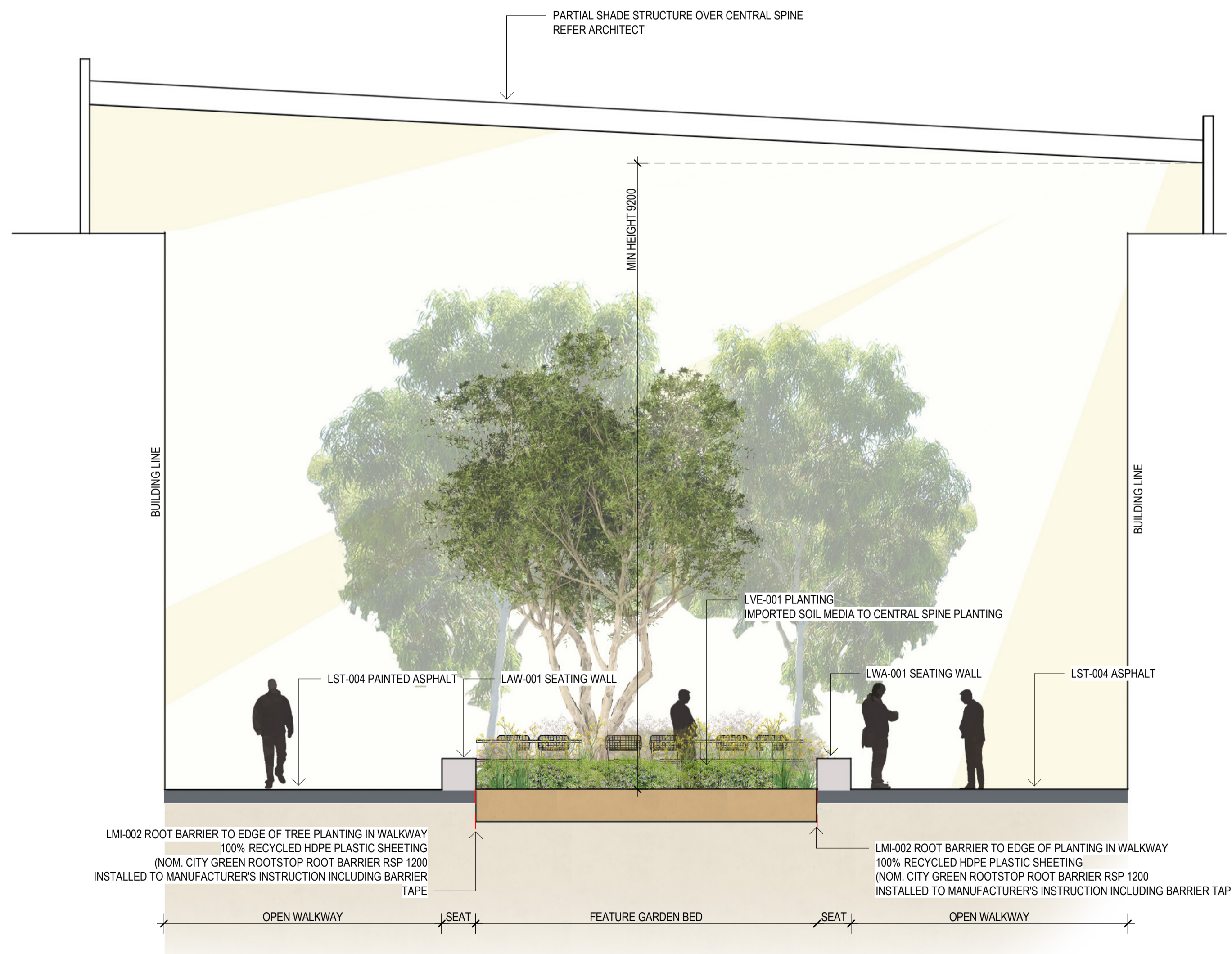

2 LANDSCAPE SPINE WALKWAY - TYPICAL CROSS SECTION  
1:50

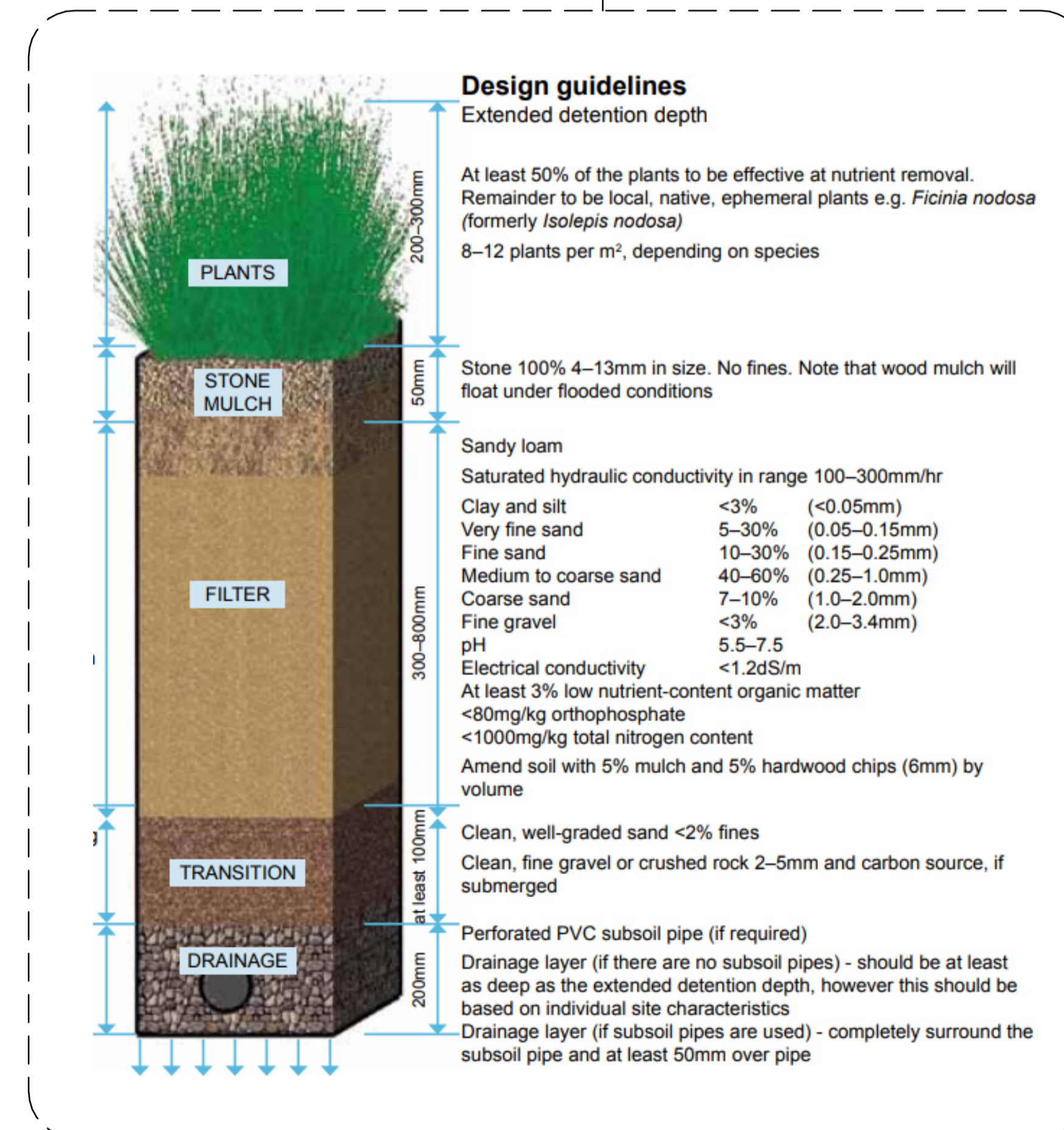

INDICATIVE SWALE PLANTING PROFILE AS PER DEPARTMENT OF WATER SENSITIVE URBAN DESIGN BIOFILTER GUIDELINES.  
FINAL PROFILE TO BE CONFIRMED IN COORDINATION WITH CIVIL ENGINEER

CONSULTANT

**Hassell**

Hassell LTD ABN 24 007 711 435  
Level 1  
Commonwealth Bank Building  
242 Murray Street  
Perth WA 6000 Australia  
T +61 8 6477 6000  
perth@hassellstudio.com

CLIENT

HOME FIRE CREATIVE INDUSTRIES

PROJECT

SCREEN PRODUCTION FACILITY

MALAGA

STATUS

DRAWING TITLE

TYPICAL SECTIONS

REVIEWED

Checker

SCALE @ A1

As indicated

APPROVED

Approver

PROJECT NO.

015195

DRAWING NO.

SPF-HSL-LA-00-480-015

REV NO.

B

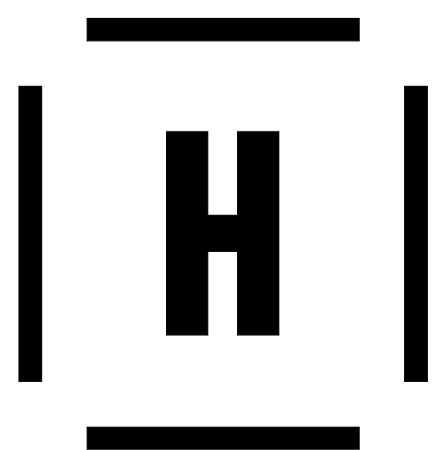



# OFFICE APPROACH

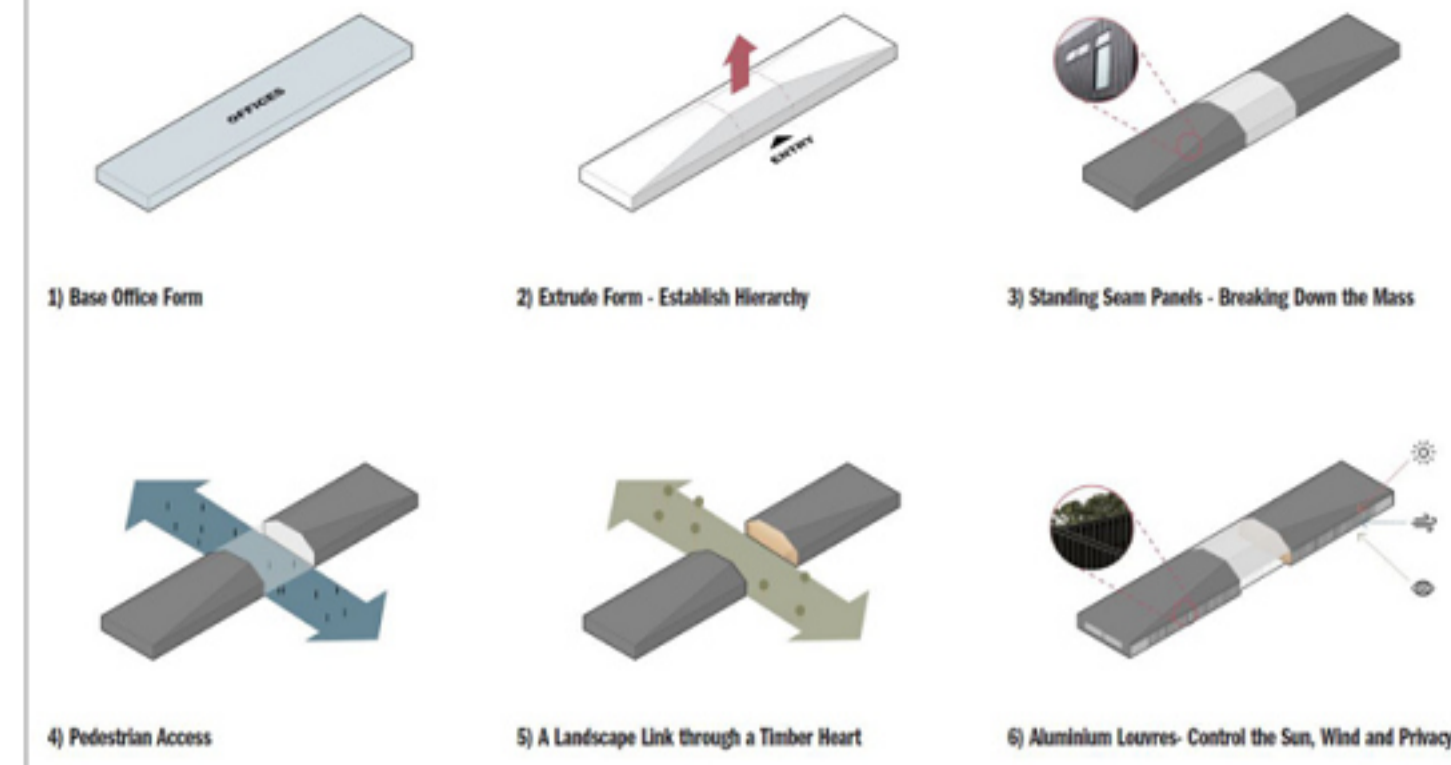

DESIGN REFERENCE - SPF OFFICE BLOCK



DESIGN REFERENCE - PRE CAST CONCRETE BENCH SEAT



NOTE: RENDERED IMAGES ARE INDICATIVE ONLY

LWA-001 SEATING WALL		
WALL TYPE	DIMENSIONS	QUANTITY
LWA-001 TYP1	2000x500x450mm	24 no.
LWA-001 TYP2	2000x500mm, 450mm sloped to 130mm	11 no.
<b>TOTAL LENGTH</b>		<b>70 m</b>

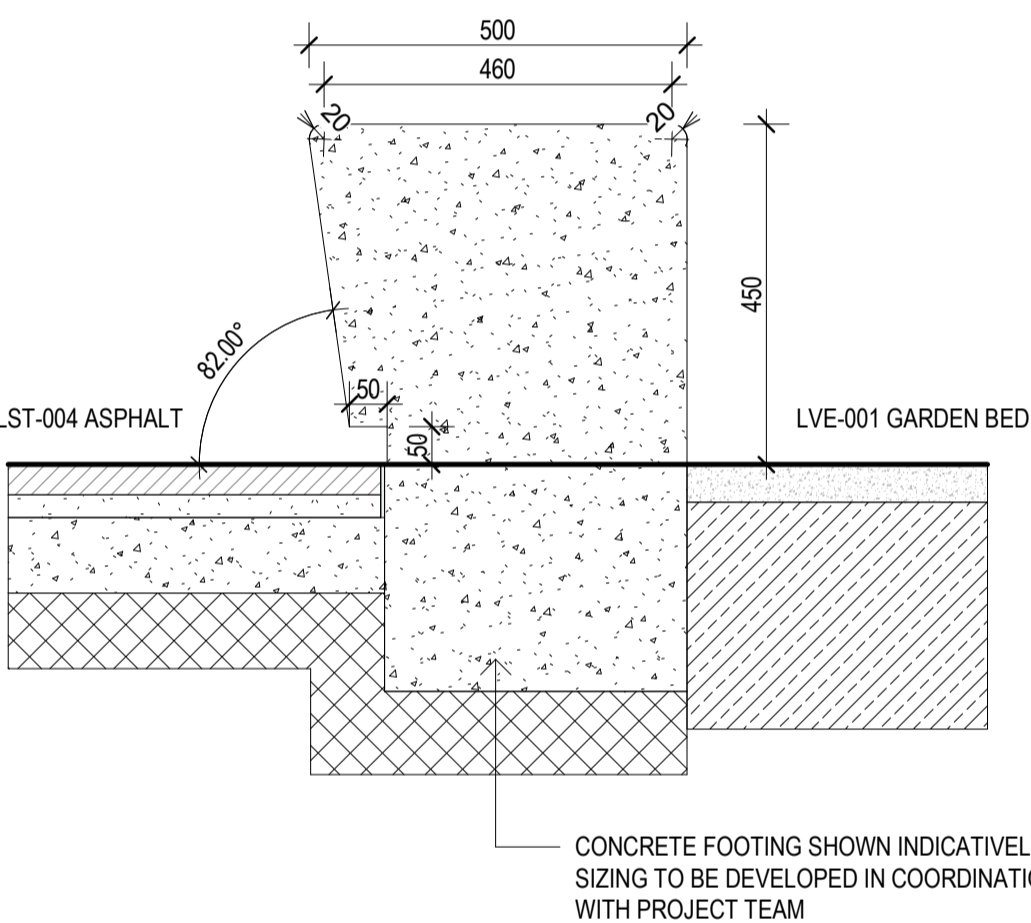

1 LWA-001 - INSITU CONCRETE SEATING WALL Copy 1  
1:10

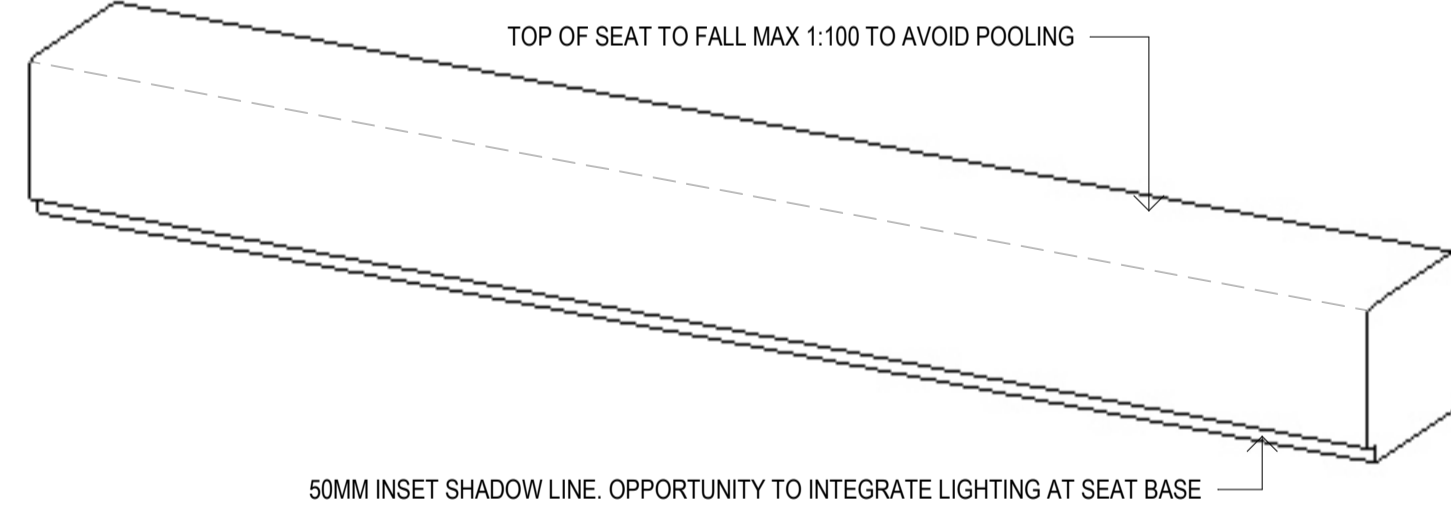

2 LWA-001\_TYP1 - INSITU CONCRETE SEATING WALL Copy 1

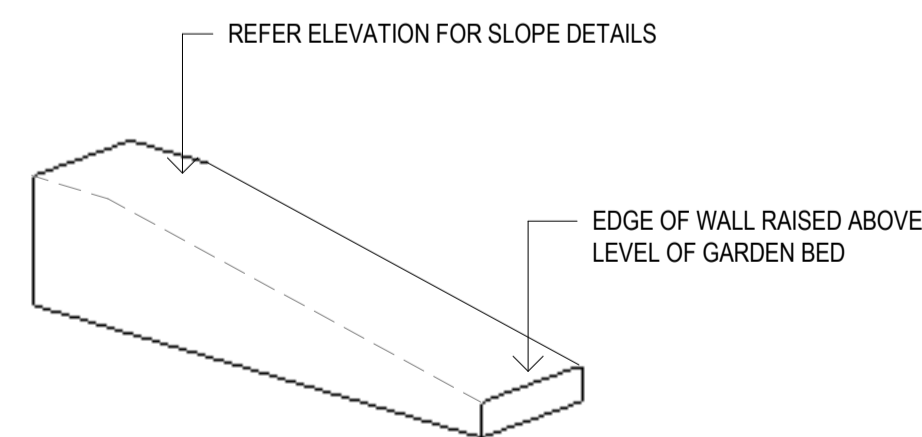

3 LWA-001 TYP2 - INSITU CONCRETE SEATING WALL Copy 1

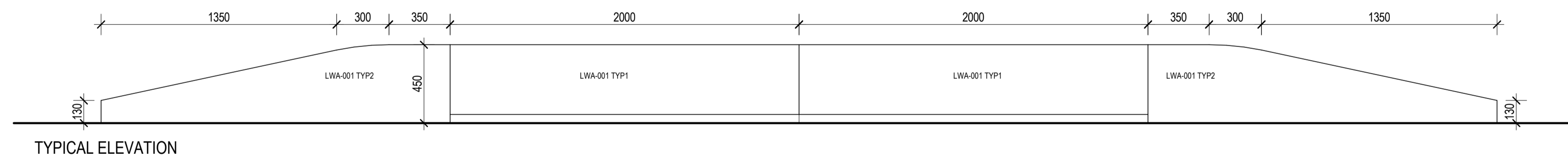

TYPICAL PLAN

4 LWA-001 - INSITU CONCRETE SEATING WALL PLAN\_ELEVATION Copy 1  
1:20

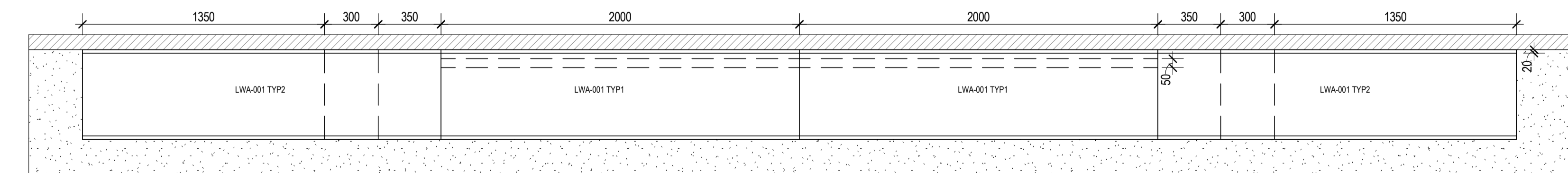

## REFERENCE MAP

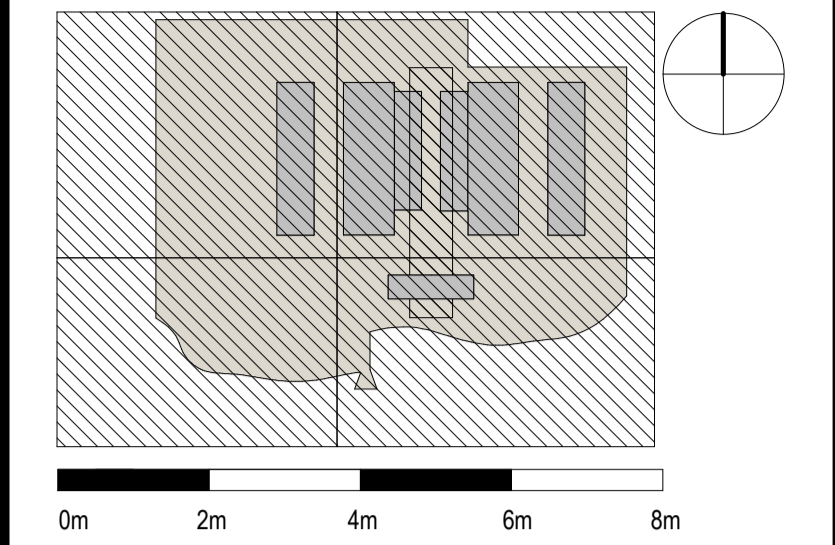

## NOTES

- Do not scale drawing. Written dimensions govern
- All dimensions are in millimeters unless noted otherwise
- All dimensions shall be verified on site before proceeding with the work. Hassell shall be notified in writing of any discrepancies.
- This drawing must be read in conjunction with all relevant contracts, specifications and drawings  
This drawing is an uncontrolled copy. Unless noted otherwise  
© Copyright of this drawing is vested in Hassell Ltd.

REV	DESCRIPTION	DATE
A	ISSUED FOR DA	09/02/2023
B	ISSUED FOR DA	09/03/2023

## CONSULTANT

**Hassell**

Hassell LTD ABN 24 007 711 435  
Level 1  
Commonwealth Bank Building  
242 Murray Street  
Perth WA 6000 Australia  
T +61 8 6477 6000  
perth@hassellstudio.com

## CLIENT

HOME FIRE CREATIVE INDUSTRIES  
PROJECT  
SCREEN PRODUCTION FACILITY  
MALAGA

## STATUS

DRAWING TITLE  
WALL DETAILS

REVIEWED  
Checker

SCALE @ A1  
As indicated

APPROVED  
Approver

PROJECT NO.  
015195

DRAWING NO.  
SPF-HSL-LA-00-480-016

REV NO.  
B

