

Appendix F

Public Art Report



Preliminary Public Art Report for Montario Quarter

Transition
Proposal Nov 2018

prepared for CCN Architects



artworks - Stuart Green

Stuart Green - Lead artist
(Director Big Spoon Art Services)

With over twenty five years' experience creating artworks for the public realm Stuart Green has created an enviable portfolio of artworks in a range of scales and themes. Based in Perth he has completed works in his home town as well as nationally and internationally. Stuart Green and Big Spoon Art Services recently being selected for the internationally competitive Al Zubara artscape project in Qatar.

His portfolio includes architectural facade treatments, monumental stand-alone artworks and smaller scale intimate interpretive pieces.

Stuart Green has a keen interest in the phenomena of the natural world and often these images and ideas generate the forms and visual structures manifest in his artwork. He has a keen interest in pattern and form, and his work often follows three threads; *line*, *object* and *field*.

Ben Price- Designer - Project delivery
(Studio - Big Spoon Art Services)

Ben and Stuart have collaborated on many projects over the years. Ben is an integral element in the success of the studio, working full time to assist in the design and delivery of many major projects produced in the studio. Ben has 15 years of experience working across the fields of Architecture, Landscape and Public Artwork and contributes this knowledge to Stuart's Artist practice.

The Studio

Big Spoon Art Services has a large production facility and full time staff able to realise the production and delivery of large and small scale public artworks and integrated services

Big Spoon Art Services
A: 27 May Holman Drive, Bassendean
M: 0407 705 692
E: stuart@stuartgreen.com.au



Transition

For the former Shenton Park Hospital, rehabilitation was a key function through its history. The public artwork for Lot 37 seeks to acknowledge this by taking a broad view of the multitude of stories and historical events, and to see the hospital's key role as one of enacting transition as an act of healing. The movement from one altered state to a more settled formed or healed state can be the subject for works of art across the site.

The public artwork for Lot 37 Montario will align to, and explore a general theme of **transition- a flow from one state to another.**

One of the Hospital's therapeutic principles was to acknowledge and create access to the natural local environment as a recuperative tool. In keeping with this history and the physical context of the site, the artwork will use botanical imagery as the key visual motif for the suite of artworks. The artworks will use the broad language of floral or botanical motifs as a base for developing the overarching idea of transition and a movement towards a more healed state.

Stories of healing and patient progression that is the history of the site, can be alluded to through the progression or transition of graphic and three dimensional representations of botanical elements. The artist see great potential in the abstract representations of the botanical motif, rather than the overt illustrative or literal depiction of these images.

These will form discreet and/or integrated artworks within the building language, and more broadly in the public realm. The use of natural materials such as terracotta and timber, juxtaposed to bronzed or warm anodised metals in the artworks, will create a unifying language. This will contribute to a sense of place – alluding to the natural history of the site and will help in developing a unified built form for this project.

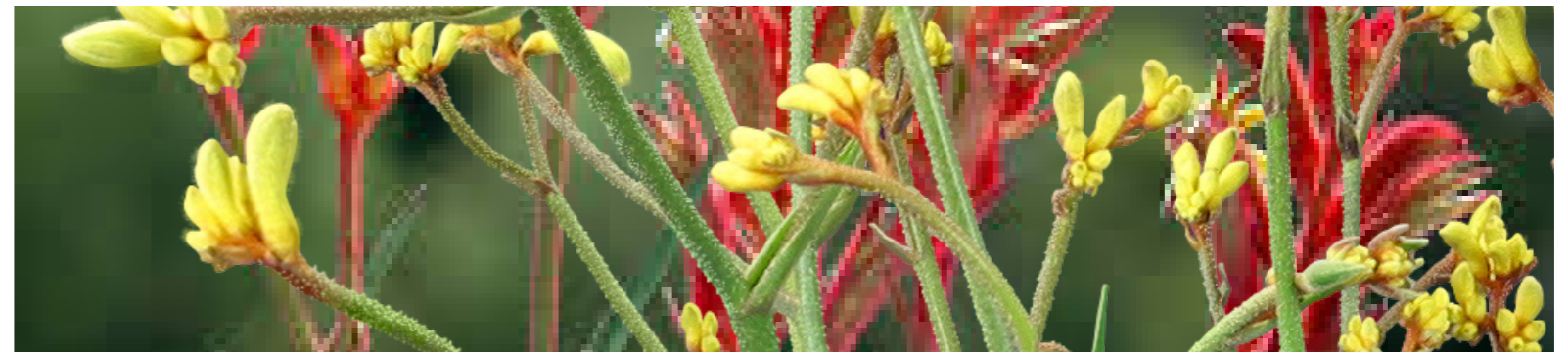

In the 1950s, Sir George Montario Bedbrook's ground-breaking research linked access to open space, gardens, plants, light and fresh air with rehabilitation progress for paraplegics. New buildings were centred around courtyards to connect patient rooms to the natural environment. This practice was carried through to the 21st Century, with a therapeutic benefit

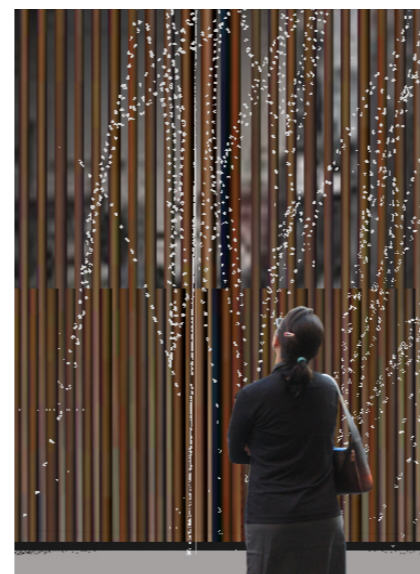

Artwork Integration

The project has many opportunities for the development of public art. Below are listed opportunities that support the development of an overarching character of place. Emphasis has been placed on sites with high pedestrian contact and the use of materials sympathetic to the heritage palette.

1. Apartment Lobby Entries

Composite terracotta wall relief to the lobby external surrounds - designed to meet and compliment the stack-bond masonry treatment in these areas. Based on developing botanical motifs

2. Upper Screen Design only

A commitment has been made to artistically treat the upper screens, by creating a unit set of patterns and imagery that can be deployed across the highly visible project component.

3. Gym screening

Timber vertical screening embellishment - allowing a super graphic botanical motif to flow across spaced verticals with use of reflective metal inlays and chamfered timber planes

4. Laneway Entry

Wall based low relief sculpture wrapping and transitioning around the corner to give low level legibility to this entry

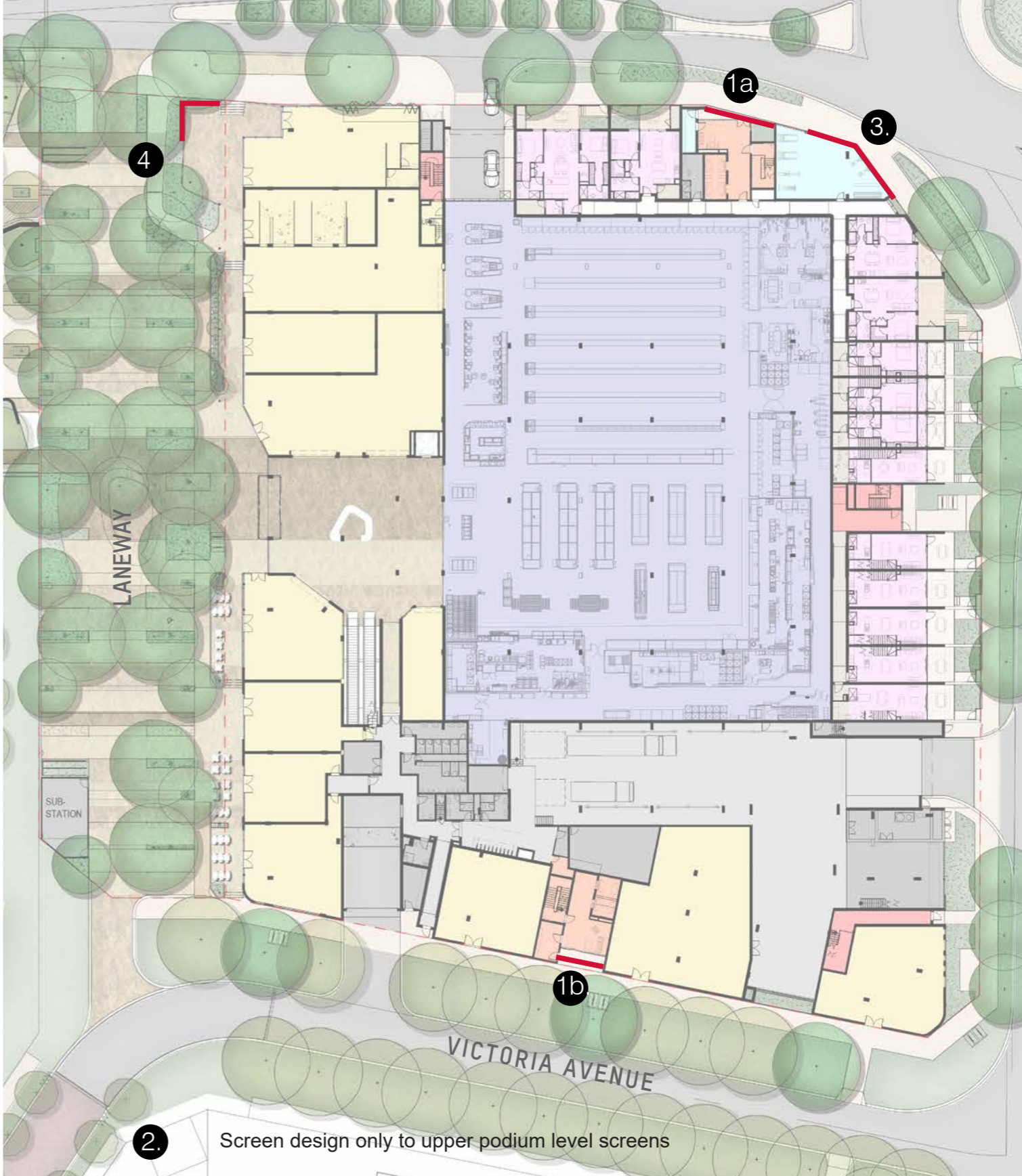

2 Screen design only to upper podium level screens



North elevation

Artwork Preliminary Description

Lobby entrances have a strong visual marker in the stack-bonded brickwork. In keeping with this language, an opportunity exists to create stack-bonded larger format relief sculpted terracotta tiles. This wall plane can depict a specific botanical reference linked to the particular lobby and build on the over-arching idea of resolution of imagery from a disturbed to a more resolved state.

Material Response

The rich terracotta colour and texture reinforces the heritage character of the site whilst specific imagery gives a unique character to each lobby and a legible marker for wayfinding. The artist is interested in both raw, clear glazed and blackened terracotta as a colour pallet.



Materiality and textural examples

Tree fork, Howard Taylor



Upper levels plan

Artwork Preliminary Description

A commitment has been made to apply to the upper screens and the podium level movable screens an artistic treatment. A range of base patterns that link to form larger imagery across a number of screens can be developed by the artist. It is expected that the artist will use an array of perforations to create suitable imagery in the metallic screens, allowing them to function as visual sun screens whilst enlivening the elevations with a finer layering of detail

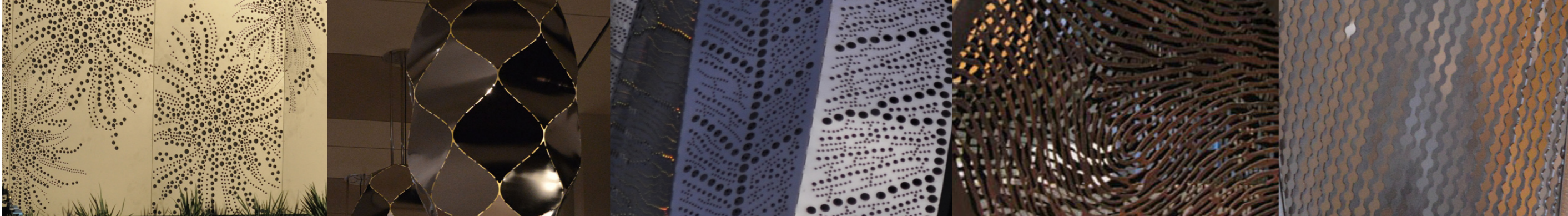

Materiality and textural examples



East elevation

Artwork Preliminary Description

Timber vertical screening can provide the canvas for inlaid reflective points of colour and sparkle to pick out botanical motifs across the surface of this screen. Alternatively the timber vertical can be carved and chamfered to allow differing light reflections to build up a pixilated image drawn from the botanical motif. A 'super graphic' approach can have large effect for the corner site and set the tone of the development. A sense of separation between the artwork and the signage is crucial to the project.

Material Response

Again the warm timbers and reflective nature of the design pick-outs give the project a character in keeping with the design guidelines. Such work allows limited views into the residents' gym whilst maintaining a view outwards. Night lighting will act in silhouette.



Materiality and textural examples



North elevation

Artwork Preliminary Description

Entry into the Laneway is flanked by high retaining walls and solid balustrading. This location offers an opportunity to develop a low relief artwork as part of the wall and paneling. It can flow around the corner giving visual vibrancy at the pedestrian level, and high legibility and entry marking for the laneway.

Material Response

Currently the wall is shown as Corten with low garden borders. The artwork can take on this materiality and lift it through the use of sympathetic colour and smoother surface treatment such as painted aluminium. There is the opportunity to pierce the materials to allow light and shadow to play through the work and allow internal lighting. The location suggests a layered treatment to the artwork that transitions around the corner site.

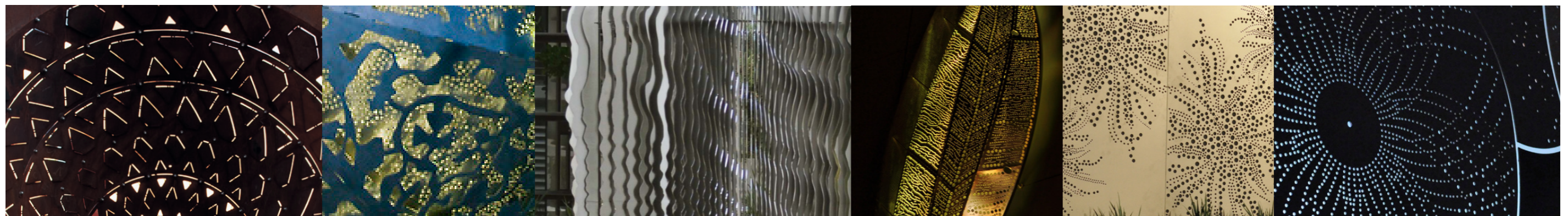

Materiality and textural examples

Commissioning process

Big Spoon Art Services would be engaged using as a base the standard Western Australian Government Percent for Art Commission Agreement.

Big Spoon Art Services with Stuart Green as lead artist would undertake the further stages;

- Concept Design
- Design Development
- Design Documentation and Engineering certification
- Fabrication
- Installation as suitable

The total commission budget is \$446,250 +GST + Any base build budget for items supplied as artworks but normally supplied through other budgets

Insured - Big Spoon Art Services Pty Ltd

ABN: 37 133 129 085

Public Liability	\$20,000,000
Product Liability	\$20,000,000
Professional Indemnity	\$5,000,000
Goods Transit	\$200,000
Workers Compensation	As per legislation

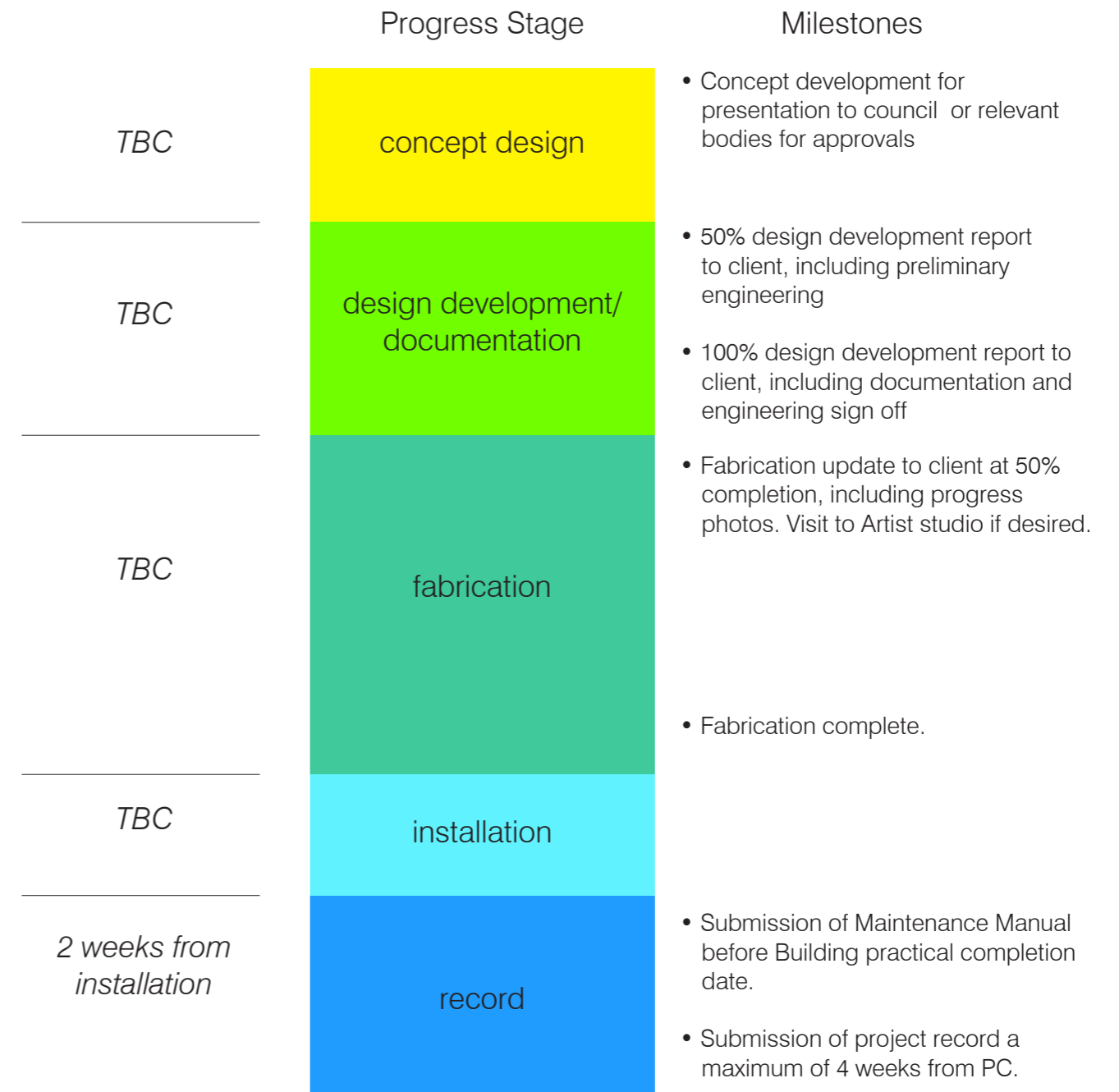

All dates to be backdated from Practical completion date of the building/ site works. Concept design can be developed immediately on acceptance of contract.

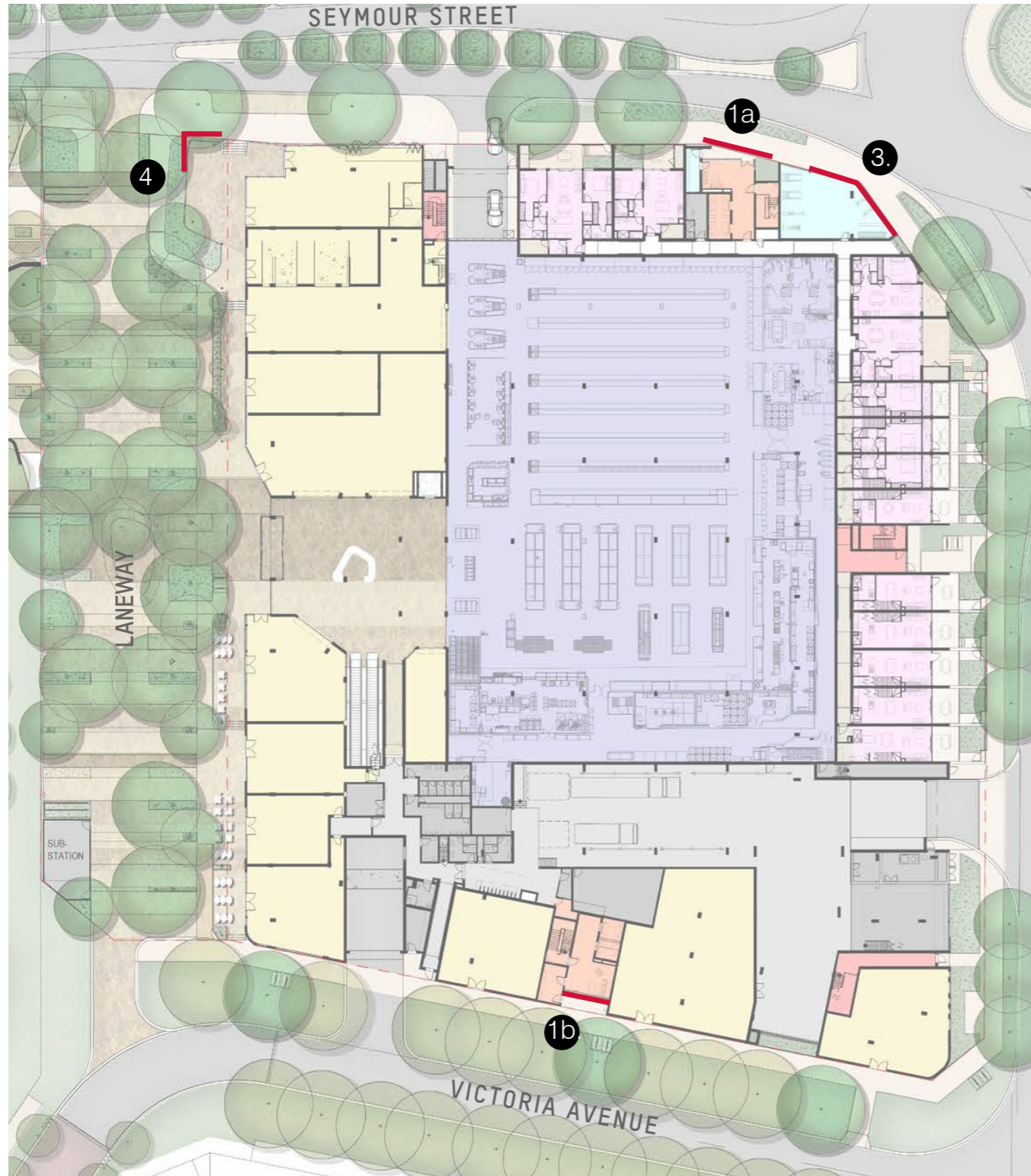

2. Screen design only to upper podium level screens (not illustrated above)

Preliminary budget by location - Nov 2018

location	Qty	Each (ex gst)	Total (ex gst)
1 Lobby Entrances (2 off)			
Design Dev & Documentaion	1	\$ 15,500.00	\$ 15,500.00
fabrication and materials	1	\$ 62,000.00	\$ 62,000.00
transport & installation	1	\$ 12,000.00	\$ 12,000.00
	1	sub total for 1	\$ 89,500.00
	2	sub total for 2	\$ 179,000.00
2 Screen Design only			
Design Dev & Documentaion	1	\$ 40,000.00	\$ 40,000.00
fabrication and installation	1	by others	
		total	\$ 40,000.00
3 Residents Gym Exterior			
Design Dev & Documentaion	1	\$ 23,000.00	\$ 23,000.00
fabrication and materials *	1	\$ 80,000.00	\$ 80,000.00
transport	1	\$ 5,000.00	\$ 5,000.00
installation	1	by others	
		total	\$ 108,000.00
4 Seymor Steet/Laneway entrance			
Design Dev & Documentaion	1	\$ 23,000.00	\$ 23,000.00
fabrication and materials *	1	\$ 85,000.00	\$ 85,000.00
transport & installation	1	\$ 11,250.00	\$ 11,250.00
	1	sub total for 1	\$ 119,250.00
TOTAL EX GST			\$ 446,250.00
Artwork Budget			\$ 446,250.00

* materials supply to be negotiated in light of base build
below ground concrete foundatins by others (Laneway /POS boundary)